



# Complete user's manual

CL82143

DECT 6.0 cordless telephone/  
answering system with  
caller ID/call waiting



# Congratulations

on your purchase of this AT&T product. Before using this AT&T product, please read the **Important safety information** section on pages 90-92 of this manual. Please thoroughly read this user's manual for all the feature operations and troubleshooting information necessary to install and operate your new AT&T product. You can also visit our website at **www.telephones.att.com** or call **1 (800) 222-3111**. In Canada, dial **1 (866) 288-4268**.

This telephone meets the California Energy Commission regulations for energy consumption. Your telephone is set up to comply with the energy-conserving standards right out of the box. No further action is necessary.

This telephone system is compatible with certain AT&T DECT 6.0 cordless headsets. Visit **www.telephones.att.com/headsets** for a list of compatible cordless headsets.

Model number: CL82143

Type: DECT 6.0 cordless telephone/answering system with caller ID/call waiting

Serial number: \_\_\_\_\_

Purchase date: \_\_\_\_\_

Place of purchase: \_\_\_\_\_

Both the model and serial numbers of your AT&T product can be found on the bottom of the telephone base.

Save your sales receipt and original packaging in case it is necessary to return your telephone for warranty service.



Telephones identified with this logo have reduced noise and interference when used with most T-coil equipped hearing aids and cochlear implants. The TIA-1083 Compliant Logo is a trademark of the Telecommunications Industry Association. Used under license.

# Complete user's manual

CL82143

DECT 6.0 cordless telephone/  
answering system with  
caller ID/call waiting



## Table of contents

### Getting started

Parts checklist .....	1
Quick reference guide - handset.....	2
Quick reference guide - telephone base.....	5
Installation.....	6
Telephone base installation.....	7
Battery installation and charging.....	8
Installation options.....	10
Tabletop to wall-mount installation.....	10
Wall-mount to tabletop installation.....	11

### Telephone settings

Handset settings.....	12
Ringer volume.....	12
Ringer tone.....	13
Set date/time .....	13
LCD language .....	14
Voice language .....	15
Caller ID announce .....	15
Set speed dial voicemail number.....	16
Voicemail (visual message waiting) indicator.....	17
Clear voicemail indicator.....	17

Rename handset.....	18
Key tone.....	18
Use caller ID to automatically set date and time .....	19
Home area code.....	19
Dial mode.....	20
Web address .....	20
QUIET mode .....	21

### Telephone operation

Handset operation .....	22
Making a call.....	22
On hook dialing (predialing) .....	22
Answering a call .....	22
Ending a call .....	22
Auto off .....	22
Temporary ringer silencing.....	23
Speakerphone .....	23
Last number redial.....	24
Equalizer.....	25
Options while on calls.....	26
Volume control .....	26
Call waiting.....	26
Mute .....	26
Chain dialing.....	27
Temporary tone dialing .....	28
Blind transfer.....	28

## Multiple handset use

Multiple handset use .....	29
Handset locator .....	29
Join a call in progress .....	29
Intercom .....	30
Answer an incoming call during an intercom call .....	31
Call transfer using intercom .....	32
Push-to-talk (PTT) .....	33
Turn incoming PTT on or off .....	33
PTT call to a single handset .....	34
PTT call to a group of handsets .....	35
Answer a PTT call .....	36
Change a one-to-one PTT call to an intercom call .....	36
Answer an incoming call during PTT .....	37
Make an outgoing call during PTT .....	37
End or leave a PTT call .....	37

## Directory

About the directory .....	38
Shared directory .....	38
Capacity .....	38
Create directory entries .....	39
Create a new directory entry .....	39
Add a predialed telephone number to the directory .....	40
Review the directory .....	41
Review directory entries .....	41
Search by name .....	42
Dial, delete or edit directory entries .....	43
Display dial .....	43
Delete a directory entry .....	43
Edit a directory entry .....	44
Speed dial .....	45
Assign a speed dial number .....	45
Reassign a speed dial number .....	46
Delete a speed dial number .....	46

Assign your speed dial voicemail number .....	47
Make a call using speed dial .....	47
Check your voicemail using speed dial .....	47

## Caller ID

About caller ID .....	48
Information about caller ID with call waiting .....	48
Caller ID log .....	49
How the caller ID log works .....	49
Missed (new) call indicator .....	49
Caller ID operation .....	50
Memory match .....	50
Review the caller ID log .....	50
View dialing options .....	51
Dial a caller ID log entry .....	51
Delete caller ID log entries .....	51
Save a caller ID log entry to the directory .....	52
Reasons for missing caller ID information .....	53

## Answering system

Answering system settings .....	54
Announcement .....	54
Answer on/off .....	56
Call screening .....	57
Number of rings .....	57
Remote access code .....	58
Message alert tone .....	59
Message recording time .....	59
About the answering system .....	60
Answering system and voicemail indicators .....	60
Using the answering machine and voicemail together .....	61
Message capacity .....	61
Voice prompts .....	62
Call screening at the telephone base .....	62



Call screening at the handset.....	62	FCC Part 68 and ACTA.....	93
Call intercept .....	62	FCC Part 15.....	95
Base ringer .....	62	California Energy Commission	
Temporarily turning off the		battery charging testing	
message alert tone.....	63	instructions.....	96
Message playback.....	64	Limited warranty.....	97
Options during playback.....	65	Technical specifications.....	99
Delete all old messages.....	66	DECT 6.0 digital technology.....	99
Recording and playing memos.....	67	Telephone operating range.....	99
Record a memo.....	67	Redefining long range coverage	
Play back a memo .....	67	and clarity .....	99
Base message counter displays.....	68	HD audio with equalizer for	
Message counter displays.....	68	customized audio.....	99
Remote access.....	69		

## Appendix

Adding and registering handsets/	
headsets.....	71
Register a handset to your	
telephone base.....	71
Deregistering handsets .....	73
Deregister all handsets from	
your telephone base.....	73
Alert tones and lights .....	74
Screen icons.....	74
Handset alert tones.....	74
Telephone base tones.....	75
Lights .....	76
Handset display screen messages...	77
Screen display messages.....	77
Troubleshooting .....	80
Maintenance.....	89
Important safety information .....	90
Safety information.....	90
Especially about cordless	
telephones .....	91
Precautions for users of	
implanted cardiac	
pacemakers.....	91
Pacemaker patients.....	91
Especially about telephone	
answering systems.....	92

## Index

Index .....	100
-------------	-----

## Getting started

### Parts checklist

Your telephone package contains the following items. Save your sales receipt and original packaging in the event warranty service is necessary.

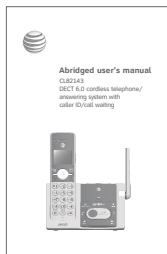

Abridged user's manual

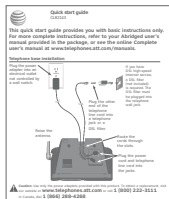

Quick start guide



Cordless handset



Telephone base



Battery for cordless handset



Battery compartment cover

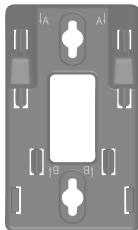

Wall-mount bracket

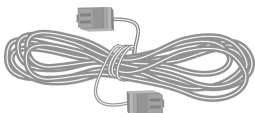

Telephone line cord



Power adapter for telephone base

# Quick reference guide - handset

## CHARGE indicator

On when the handset is charging in the telephone base or charger.

## ▼CID/VOLUME

- Press ▼**CID** to show the caller ID log when the handset is not in use (page 50).
- Press to scroll down while in menus.
- While entering names or numbers, press to move the cursor to the left.
- Press to decrease the listening volume when on a call (page 26), or to decrease the message playback volume (page 65).

## REDIAL/PAUSE

- Press repeatedly to view the last 10 numbers dialed (page 24).
- While entering numbers, press and hold to insert a dialing pause (page 39).

## PHONE/FLASH

- Press to make or answer a call.
- During a call, press to answer an incoming call when you receive a call waiting alert (page 26).

## 1

- While reviewing a caller ID log entry, press repeatedly to add or remove 1 in front of the telephone number before dialing or saving it in the directory (page 51).
- Press and hold to set (page 16) or dial your voicemail number (page 47).

## TONE\* / a>A

- Press to switch to touch-tone dialing temporarily during a call if you have pulse service (page 28).
- While entering names, press to change the next letter to upper or lower case.

## /SPEAKER

Press to switch between the speakerphone and the handset (page 23).

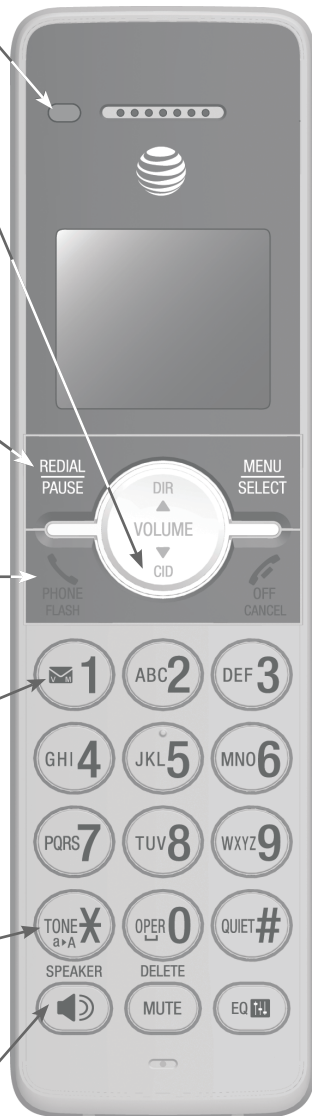

# Getting started

## Quick reference guide - handset



### ▲DIR/VOLUME

- Press ▲DIR to show directory entries (page 41) when the handset is not in use.
- Press to scroll up while in menus.
- While entering names or numbers, press to move the cursor to the right.
- Press to increase the listening volume when on a call (page 26), or to increase the message playback volume (page 65).

### MENU/SELECT

- Press to show the menu.
- While in the menu, press to select an item or save an entry or setting.

### ☎ OFF/CANCEL

- During a call, press to hang up.
- While in a menu, press to cancel an operation, back up to the previous menu, or exit the menu display; or press and hold this key to exit to idle mode.
- Press and hold while the telephone is not in use to erase the missed call indicator.

### QUIET # (pound key)

- Press repeatedly to display other dialing options when reviewing a caller ID log entry (page 51).
- Press and hold to enter the **QUIET** mode setting screen, or to deactivate **QUIET** mode (page 21).

### EQ

During an outside call, intercom call, message or announcement playback, press to change the audio quality to best suit your hearing (page 25).

### MUTE/DELETE

- During a call, press to mute the microphone.
- While reviewing the caller ID log, the directory or the redial memory, press to delete an individual entry.
- While predialing (page 22), press to delete digits.

# Getting started

## Quick reference guide - handset

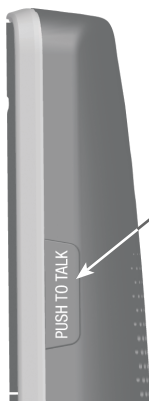

### PUSH TO TALK

- Press to initiate a one-to-one (page 34) or one-to-group (page 35) broadcast or to turn PTT on or off (page 34).
- Press and hold to broadcast to a group of handsets (page 35).

### Main menu

The > symbol highlights a menu item.

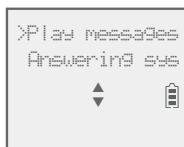

### Main menu

- Play messages (page 64)
- Answering sys (page 54)
- Directory (page 38)
- Caller ID log (page 48)
- Intercom (page 30)
- Ringers (page 12)
- Set date/time (page 13)
- Settings (page 14)
- Web address (page 20)

### Using menus:

- Press **MENU/SELECT** to show the menu.
- Press **▼CID** or **▲DIR** to scroll through menu items.
- Press **MENU/SELECT** to confirm or save changes to a highlighted menu item.
- Press **OFF/CANCEL** to cancel an operation, back up to the previous menu, or exit the menu display.



## Quick reference guide - telephone base

### /ANSWER ON/OFF

Press to turn the built-in answering system on or off (page 56).

### /HANDSET LOCATOR

- While the phone is idle, press to page all handsets (page 29).
- Press and hold to begin handset deregistration (page 73).

### IN USE indicator

- On when the handset is in use, or when the answering system is answering an incoming call.
- On when a handset is being registered.
- Flashes when there is an incoming call or when handsets are being deregistered.
- Flashes when another telephone is in use on the same line.

### X/DELETE

- Press to delete the message currently playing (page 65).
- Press twice to delete all old messages when the phone is not in use (page 66).

### ▼/VOL- and ▲/VOL+

- During message playback, press to adjust the listening volume (page 65).
- While in idle mode, press to adjust the base ringer volume (page 62).

### ◀/REPEAT

- Press to repeat a message.
- Press twice to play the previous message (page 65).

### Message counter

Shows the number of messages or other answering system information (page 68).

### ▶/■/PLAY/STOP

Press to start or stop message playback (page 64).

### ▶/SKIP

Press to skip a message (page 65).

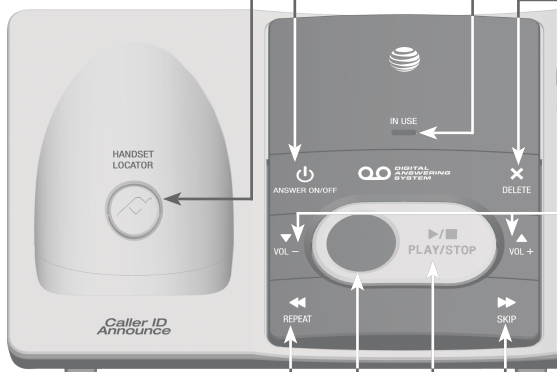

You must install and charge the battery before using the telephone.



**STOP!**

See pages 8-9 for easy instructions.

Install the telephone base close to a telephone jack and a power outlet not controlled by a wall switch. The telephone base can be placed on a flat surface or vertically mounted on the wall (see page 10). For optimum range and better reception, place the telephone base in a central and open location.

If you subscribe to high-speed Internet service (DSL - digital subscriber line) through your telephone line, you must install a DSL filter between the telephone line cord and the telephone wall jack (see the following page). The filter prevents noise and caller ID problems caused by DSL interference. Please contact your DSL service provider for more information about DSL filters.

Your product may be shipped with a protective sticker covering the handset or telephone base display - remove it before use.

For customer service or product information, visit our website at **[www.telephones.att.com](http://www.telephones.att.com)** or call **1 (800) 222-3111**. In Canada, dial **1 (866) 288-4268**.

**Avoid placing the telephone base too close to:**

- Communication devices such as television sets, VCRs, or other cordless telephones.
- Excessive heat sources.
- Noise sources such as a window with traffic outside, motors, microwave ovens, refrigerators, or fluorescent lighting.
- Excessive dust sources such as a workshop or garage.
- Excessive moisture.
- Extremely low temperature.
- Mechanical vibration or shock such as on top of a washing machine or workbench.

## Telephone base installation

Install the telephone base, as shown below.

The telephone base is ready for tabletop use. If you want to change to wall-mounting, see **Installation options** on page 10 for details.

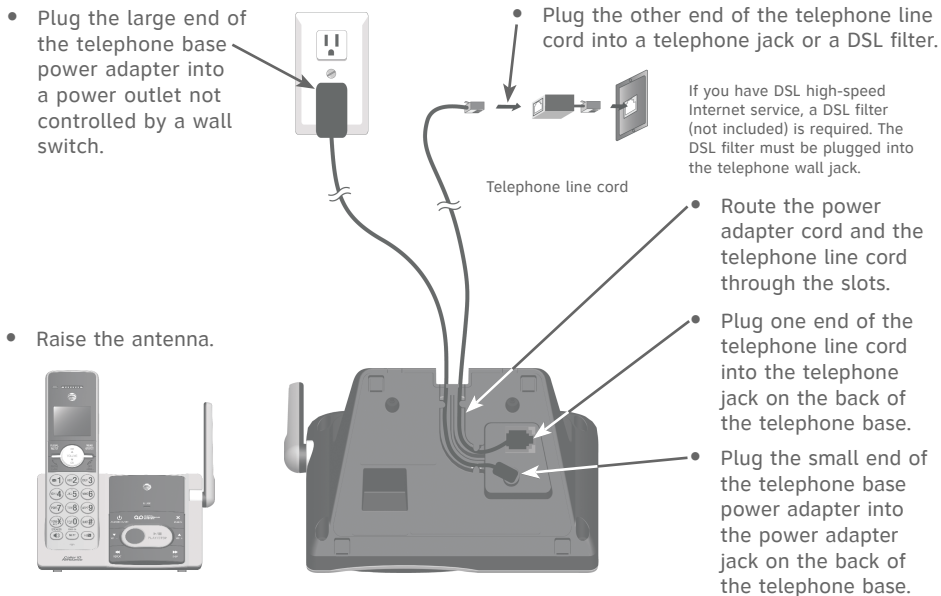

### IMPORTANT INFORMATION



1. Use only the power adapters supplied with this product. To order a replacement power adapter, visit our website at **[www.telephones.att.com](http://www.telephones.att.com)** or call **1 (800) 222-3111**. In Canada, dial **1 (866) 288-4268**.
2. The power adapters are intended to be correctly oriented in a vertical or floor mount position. The prongs are not designed to hold the plug in place if it is plugged into a ceiling, under-the-table or cabinet outlet.



## Battery installation and charging

Install the battery, as shown below. Once you have installed the battery, the screen indicates the battery status (see the following table). If necessary, place the handset in the telephone base or charger to charge the battery. For best performance, keep the handset in the telephone base or charger when not in use. The battery is fully charged after 10 hours of continuous charging. See the table on page 99 for battery operating times.

If the screen shows **Place in charger** and  flashes, you need to charge the handset without interruption for at least 30 minutes to give the handset enough charge to use the telephone for a short time. The following table summarizes the battery charge indicators and actions to take.

Battery indicators	Battery status	Action
The screen is blank, or shows <b>Place in charger</b> and  (flashing).	Battery has no or very little charge. The handset cannot be used.	Charge without interruption (at least 30 minutes).
The screen shows <b>Low battery</b> and  (flashing).	Battery has enough charge to be used for a short time.	Charge without interruption (at least 30 minutes).
The screen shows <b>HANDSET X.</b>	Battery is charged.	To keep the battery charged, place it in the telephone base or charger when not in use.



**NOTE:** If you are on a phone call in low battery mode, you hear 4 short beeps every minute.

1. Plug the battery connector securely into the socket inside the handset battery compartment. Insert the supplied battery with the label **THIS SIDE UP** facing up, as indicated.

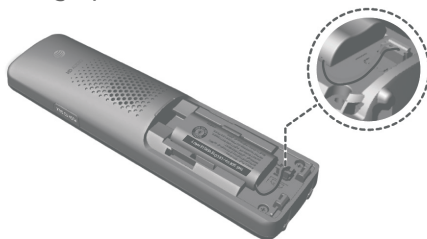

## Battery installation and charging

2. Align the cover flat against the battery compartment, then slide it upwards until it clicks into place.

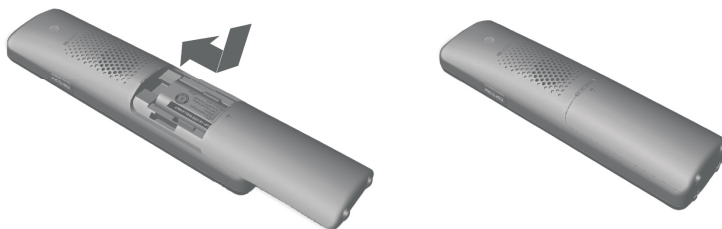

### CHARGE light



3. Charge the handset by placing it face forward in the telephone base or charger. The **CHARGE** light on the top of the handset is on during charging.

After you install your telephone or power returns following a power outage, the handset will prompt you to set the date and time. For instructions, see **Set date/time** on page 13. To skip setting the date and time, press **OFF/CANCEL**.



## IMPORTANT INFORMATION

1. Use only the supplied rechargeable battery or replacement battery (model BT183342/ BT283342). To order, visit our website at **[www.telephones.att.com](http://www.telephones.att.com)** or call **1 (800) 222-3111**. In Canada, dial **1 (866) 288-4268**.
2. If you do not use the handset for a long time, disconnect and remove the battery to prevent possible leakage.

## Installation options

Your telephone base is ready for tabletop use. If you want to mount your telephone on a wall, use the provided wall-mount bracket to connect with a standard dual-stud telephone wall-mounting plate. If you do not have this mounting plate, you can purchase one from many hardware or consumer electronic retailers. You might need a professional to install the mounting plate.

### Tabletop to wall-mount installation

1. With the upper tabs (marked **A**) on top, align the holes of the wall-mount bracket with the studs on the standard wall-mounting plate and slide the bracket down until it locks securely.
2. Plug one end of the telephone line cord into the jack on the bottom of the telephone base and plug the other end into the telephone wall jack (or DSL filter). Plug the small end of the telephone base power adapter into the jack on the bottom of the telephone base and plug the other end into an electrical outlet not controlled by a wall switch. Route the telephone line cord and the power cord through the grooves at the bottom of the telephone base, accordingly.
3. Hold the cords to the side of the telephone base. Align the upper slots on the back of the telephone base just above the upper tabs of the wall-mount bracket. Make sure the lower slots of the telephone base are also aligned above the lower tabs of the wall-mount bracket. Push the telephone base down and against the wall-mount bracket until it clicks securely in place.
4. If necessary, bundle the telephone line cord and power adapter cord neatly with twist ties.

①

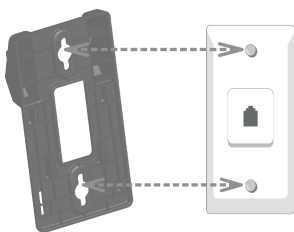

②



③

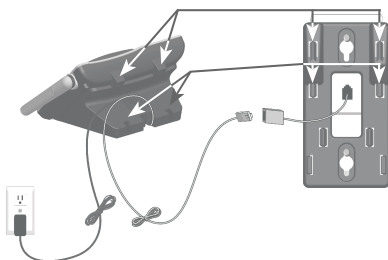

④

Raise the antenna

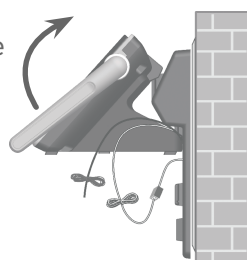

## Installation options

### Wall-mount to tabletop installation

---

To change the telephone base from the wall-mount installation to tabletop installation, follow the steps.

1. Unplug the large end of the power adapter from the electrical outlet.
2. If the telephone line cord and power adapter cord are bundled, untie them first. Slide the wall-mount bracket up and remove it from the wall-mounting plate.

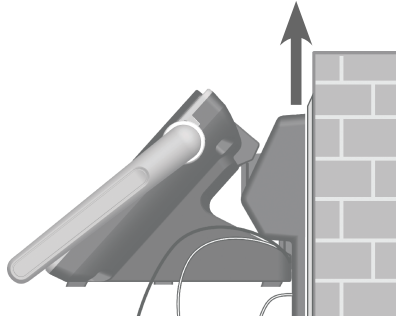

3. Unplug the telephone line cord or the DSL filter from the telephone wall jack. Push the telephone base up and away from the wall-mount bracket to detach it from the wall-mount bracket.
4. See **Telephone base installation** on page 7.



## Handset settings

Use the menu to change the telephone settings.

1. Press **MENU/SELECT** when in idle mode (when the phone is not in use) to enter the main menu.
2. Press **▼CID** or **▲DIR** to scroll to the feature to be changed. When scrolling through the menu, the **>** symbol indicates the selected menu item.
3. Press **MENU/SELECT** to select the highlighted item.



**NOTE:** Press **OFF/CANCEL** to cancel an operation, back up to the previous menu or exit the menu display. Press and hold **OFF/CANCEL** to return to idle mode.

### Ringer volume

You can set the ringer volume level (1-6) to one of six levels or turn the ringer off. When the ringer is off,  appears on the screen.

1. Press **MENU/SELECT** in idle mode to enter the main menu.
2. Use **▼CID** or **▲DIR** to scroll to **>Ringers**, then press **MENU/SELECT**.
3. Press **MENU/SELECT** again to select **>Ringer volume**.
4. Press **▼CID** or **▲DIR** to sample each volume level.
5. Press **MENU/SELECT** to save your preference. There is a confirmation tone and the screen returns to the previous menu.



#### NOTES:

- The handset ringer volume also determines the ringer volume for intercom calls.
- If the ringer volume is set to off, that handset is silenced for all incoming calls. However, the handset still plays the paging tone when responding to the handset locator.
- If the ringer volume is set to off, caller ID will not be announced and **Caller ID won't be announced** displays briefly on the screen.



## Handset settings

**Ringer tone**

You can choose one of 10 ringer tones.

1. Press **MENU/SELECT** in idle mode to enter the main menu.
2. Use ▼**CID** or ▲**DIR** to scroll to >**Ringers**, then press **MENU/SELECT**.
3. Press ▼**CID** or ▲**DIR** to scroll to >**Ringer tone**, then press **MENU/SELECT**.
4. Press ▼**CID** or ▲**DIR** to sample each ringer tone.
5. Press **MENU/SELECT** to save your preference. There is a confirmation tone and the screen returns to the previous menu.



**NOTE:** If you turn off the ringer volume, you do not hear ringer tone samples.

**Set date/time**

The answering system announces the day and time of each message prior to playing it. Before using the answering system, set the date and time as follows. If you subscribe to caller ID service, the day, month and time are set automatically with each incoming call. The year must be set so that the day of the week can be calculated from the caller ID information. You can turn off the date and time settings of the caller ID service and set the date and time manually (see **Use caller ID to automatically set date and time** on page 19).

After a power failure or handset registration, the system reminds you to set the date and time.

Follow the steps to set the month, day, year and time.

1. When the handset is in idle mode, press **MENU/SELECT** to enter the main menu.
2. Press ▼**CID** or ▲**DIR** to scroll to >**Set date/time** and then press **MENU/SELECT**.
3. Press ▼**CID** or ▲**DIR** to select the month, then press **MENU/SELECT**, or enter the number using the dialing keys.



## Handset settings

4. Press **▼CID** or **▲DIR** to select the day, then press **MENU/SELECT**, or enter the number using the dialing keys.
5. Press **▼CID** or **▲DIR** to select the year, then press **MENU/SELECT**, or enter the number using the dialing keys, then press **MENU/SELECT** to move on to set the time.
6. Press **▼CID** or **▲DIR** to select the hour, then press **MENU/SELECT**, or enter the number using the dialing keys.
7. Press **▼CID** or **▲DIR** to select the minute, then press **MENU/SELECT**, or enter the number using the dialing keys.
8. Press **▼CID** or **▲DIR** to highlight **AM** or **PM**, or press **2** for **AM** or **7** for **PM**. Press **MENU/SELECT** to confirm. There is a confirmation tone and the screen returns to the previous menu.



**NOTE:** If the clock is not set when a message is recorded, the system announces, "Time and day not set," before it plays the message.

## LCD language

You can select the language used for all screen displays.

1. Press **MENU/SELECT** in idle mode to enter the main menu.
2. Use **▼CID** or **▲DIR** to scroll to **>Settings**, then press **MENU/SELECT**.
3. Press **MENU/SELECT** to choose **>LCD language**.
4. Press **▼CID** or **▲DIR** to highlight **>English**, **>Français** or **>Español**, then press **MENU/SELECT**. The screen prompts **Set English/Français/Español as LCD language?**.
5. Press **MENU/SELECT** to confirm. There is a confirmation tone and the screen returns to the previous menu.

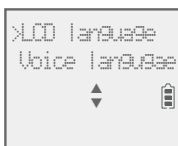

**NOTE:** If you accidentally change the LCD language to French or Spanish, you can reset it back to English without going through the French or Spanish menus. Press **MENU/SELECT** in idle mode, then enter **364#**. There is a confirmation tone.

## Handset settings

### Voice language

You can select the voice language (English or French) to be used for the voice prompts in your answering system or caller ID announce.

1. Press **MENU/SELECT** in idle mode to enter the main menu.
2. Use **▼CID** or **▲DIR** to scroll to **>Settings**, then press **MENU/SELECT**.
3. Use **▼CID** or **▲DIR** to scroll to **>Voice language**, then press **MENU/SELECT**.
4. Press **MENU/SELECT** to choose **>Answering sys**, then press **MENU/SELECT**.

**-OR-**

Use **▼CID** or **▲DIR** to scroll to **>Caller ID annnc**, then press **MENU/SELECT**.

5. Press **▼CID** or **▲DIR** to choose **>English** or **>Français**, then press **MENU/SELECT** to confirm your selection. You hear a confirmation tone.



### Caller ID announce

The caller ID announce feature lets you know who's calling without having to look at the display. When you have an incoming call, the handset and/or base speaks "Call from..." and the name of the caller based on the directory or caller ID information. If the caller's name is private or unknown, the phone number up to the last 11 digits will be spoken. If the caller's phone number is also private or unknown, no information will be spoken. By default, the caller ID announce feature is programmed **On**.

#### To turn on/off the caller ID announce on your handset or base:

1. Press **MENU/SELECT** in idle mode to enter the main menu.
2. Use **▼CID** or **▲DIR** to scroll to **>Settings**, then press **MENU/SELECT**.
3. Use **▼CID** or **▲DIR** to scroll to **>Caller ID annnc**, then press **MENU/SELECT**.
4. Use **▼CID** or **▲DIR** to highlight the desired option, then press **MENU/SELECT**.
  - **Set all On/Off** - Change the setting for the base and all handsets.
  - **Local handset** - Change the setting for that handset only.
  - **Base** - Change the setting for the telephone base only.





## Handset settings

- Use **▼CID** or **▲DIR** to highlight **>On** or **>Off**, then press **MENU/SELECT**. There is a confirmation tone and the screen returns to the previous menu. If you change the setting for **Set all On/Off**, the screen shows **CID Annnc ON/OFF on all HS & BS**.



### NOTES:

- To use the caller ID announce feature, you must subscribe to caller ID service from your telephone service provider.
- When there are up to 5 handsets registered, the telephone system supports caller ID announce for all handsets. If 6 or more handsets are registered, the system supports caller ID announce for the first 4 registered handsets only.
- This feature does not announce information for call waiting calls.
- It takes at least 2 rings for the phone to receive caller ID information and announce it. If the phone is answered before the end of the second ring, the phone won't have time to announce the caller's information.
- Pronunciation of names may vary with this feature. Not all names may be pronounced correctly.
- Caller ID announce is available in English and French.

## Set speed dial voicemail number

This feature lets you save your voicemail number for easy access when you press and hold the **1** key.

### To set your voicemail number:

- Press **MENU/SELECT** in idle mode to enter the main menu.
- Use **▼CID** or **▲DIR** to scroll to **>Settings**, then press **MENU/SELECT**.
- Use **▼CID** or **▲DIR** to scroll to **>Voicemail #**, then press **MENU/SELECT**.
- Use the dialing keys to enter the voicemail access number provided by your telephone service provider (up to 30 digits) when prompted.
  - Press **▼CID** or **▲DIR** to move the cursor to the left or right.
  - Press **MUTE/DELETE** to erase a digit.
  - Press and hold **MUTE/DELETE** to erase all digits.
  - Press **REDIAL/PAUSE** to enter a three-second dialing pause (a **p** appears).
- Press **MENU/SELECT** to save. **Voicemail # saved** shows on the handset.



## Handset settings

### Voicemail (visual message waiting) indicator

If you subscribe to a voicemail service offered by your telephone service provider, this feature provides a visual indication when you have new voicemail messages.

**New voicemail** and the  icon appear on the handset screen.



#### NOTES:

- This feature does not indicate new messages recorded on your phone's built-in answering system.
- For more information about the difference between your answering system and voicemail, see page 61.

### Clear voicemail indicator

Use this feature when the telephone indicates there is new voicemail but there is none. For example, when you have accessed your voicemail while away from home. This feature only turns off the displayed **New voicemail** and the  icon; it does not delete your voicemail messages. As long as you have new voicemail messages, your telephone service provider continues to send the signal to turn on the indicator.

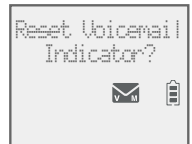

#### To manually turn off the new voicemail indicators:

1. Press **MENU/SELECT** when in idle mode to enter the main menu.
2. Use **▼CID** or **▲DIR** to scroll to **>Settings**, then press **MENU/SELECT**.
3. Use **▼CID** or **▲DIR** to scroll to **>Clr voicemail**, then press **MENU/SELECT**. The screen shows **Reset Voicemail Indicator?**.
4. Press **MENU/SELECT** again to turn the voicemail indicator off. There is a confirmation tone and the screen returns to the previous menu.



#### NOTES:

- Your telephone service provider voicemail might alert you to new messages with a stutter (broken) dial tone. Contact your telephone service provider for more details.
- For information about using your voicemail service, contact your telephone service provider.

# Handset settings

## Rename handset

You can create a handset name for each system handset.

1. When the handset is idle, press **MENU/SELECT**.
2. Use ▼**CID** or ▲**DIR** to scroll to >**Settings**, then press **MENU/SELECT**.
3. Use ▼**CID** or ▲**DIR** to scroll to >**Rename handset**, then press **MENU/SELECT**.
4. Change the handset name when prompted.
  - Press ▼**CID** or ▲**DIR** to move the cursor to the left or right.
  - Use the dialing keys to enter a name (up to 11 characters). Each time you press a key, a character on that key appears. Additional key presses produce other characters on that key. See the chart on page 40.
  - Press **MUTE/DELETE** to backspace and delete characters.
  - Press and hold **MUTE/DELETE** to delete all characters.
5. Press **MENU/SELECT** to save the setting and return to the previous menu. There is a confirmation tone.



## Key tone

The handset is set to beep with each key press. You can adjust the key tone volume or turn it off. If you turn off the key tone, there are no beeps when you press keys.

1. Press **MENU/SELECT** in idle mode to enter the main menu.
2. Use ▼**CID** or ▲**DIR** to scroll to >**Settings**, then press **MENU/SELECT**.
3. Use ▼**CID** or ▲**DIR** to scroll to >**Key tone**, then press **MENU/SELECT**.
4. Use ▼**CID** or ▲**DIR** to select the desired volume or **Off**.
5. Press **MENU/SELECT** to save your preference. There is a confirmation tone and the screen returns to the previous menu.



## Handset settings

**Use caller ID to automatically set date and time**

Follow the steps to turn the **CID time sync** feature on or off. The default setting is **On**.

1. When the handset is in idle mode, press **MENU/SELECT** to enter the main menu.
2. Press **▼CID** or **▲DIR** to scroll to **>Settings**, then press **MENU/SELECT**.
3. Press **▼CID** or **▲DIR** to scroll to **>CID time sync**, then press **MENU/SELECT**.
4. Press **▼CID** or **▲DIR** to highlight **>On** or **>Off**, then press **MENU/SELECT** to save. There is a confirmation tone and the screen returns to the previous menu.

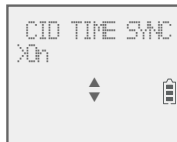
**Home area code**

If you dial 7 digits to make a local call (no area code required), enter your area code into the telephone as the home area code. When you receive a call from within your home area code, the caller ID log only displays the seven digits of the telephone number.

This feature makes it easy for you to place a call from the caller ID log. If you dial 10 digits to make a local phone call, do not use this home area code feature. If you do, you cannot place local calls from your caller ID log, as they will have only seven digits.

**To set the home area code:**

1. Press **MENU/SELECT** in idle mode to enter the main menu.
2. Use **▼CID** or **▲DIR** to scroll to **>Settings**, then press **MENU/SELECT**.
3. Use **▼CID** or **▲DIR** to scroll to **>Home area code**, then press **MENU/SELECT**. The screen briefly shows **Only for 7digit dial from CID**.
4. Use the dialing keys to enter a three-digit home area code.
  - Press **MUTE/DELETE** to delete a digit.
  - Press and hold **MUTE/DELETE** to delete all digits.
5. Press **MENU/SELECT** to save. There is a confirmation tone and the screen shows **Area code will not show in CID** briefly before returning to the previous menu.



## Handset settings



**NOTE:** If in the future, your telephone service provider requires you to dial 10 digits to make a local call (area code plus telephone number), you need to delete your home area code and dial out locally from the caller ID log. With the home area code displayed, press and hold **MUTE/DELETE** until the digits are deleted, and then press **MENU/SELECT**.

The home area code is now restored to its default setting of \_ \_ \_ (empty).

### Dial mode

The dial mode is preset to tone dialing. If you have pulse (rotary) service, you must change the dial mode to pulse dialing before using the telephone.

#### To set the dial mode:

1. Press **MENU/SELECT** in idle mode to enter the main menu.
2. Use ▼**CID** or ▲**DIR** to scroll to >**Settings**, then press **MENU/SELECT**.
3. Use ▼**CID** or ▲**DIR** to scroll to >**Dial mode**, then press **MENU/SELECT**.
4. Use ▼**CID** or ▲**DIR** to highlight >**Touch-tone** or >**Pulse**, then press **MENU/SELECT**. The screen shows **DIAL MODE is touch-tone** or **DIAL MODE is pulse**. There is a confirmation tone and the screen returns to the previous menu.

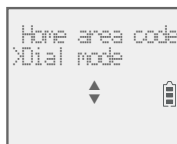

### Web address

Use this feature to view the AT&T website address.

1. Press **MENU/SELECT** in idle mode to enter the main menu.
2. Use ▼**CID** or ▲**DIR** to scroll to >**Web address**, then press **MENU/SELECT**.



## Handset settings

### QUIET mode

---

When **QUIET** mode is turned on, the telephone silences all sounds (except the handset locator paging tone) during the set period of time (1-12 hours). After you turn on **QUIET** mode, this feature activates immediately and the answering system turns on automatically. When **QUIET** mode is on, the answering system takes calls and records messages without broadcasting them.

#### To turn QUIET mode on:

1. Press and hold QUIET # in idle mode to enter the **QUIET** mode setting screen. The screen shows **Quiet: \_\_ hours (1-12 hours)**.
2. Use the dialing keys to enter the desired number of hours (1-12) you would like to turn on **QUIET** mode, then press **MENU/SELECT**. Your screen briefly shows **Answering sys is ON** and then **Quiet mode on**.

#### To turn QUIET mode off:

- While **QUIET** mode is on, press and hold QUIET #. The screen shows **Quiet mode is off** and you hear a confirmation tone.



#### NOTES:

- If you change the base ringer, handset ringer, ringer volume, key tone, or caller ID announce features when **QUIET** mode is on, the sample plays but the feature is still muted after saving the setting.
- After **QUIET** mode is turned off or the set period of time has expired, all muted features will be activated again.
- The PTT function is not available when **QUIET** mode is on.
- Intercom is available during **QUIET** mode, but the handset will not ring.

## Handset operation

### Making a call

- Press **\PHONE/FLASH** or **🔊/SPEAKER**, then enter the telephone number.

The screen displays the elapsed time as you talk (in hours, minutes and seconds).



**NOTE:** Pressing **\PHONE/FLASH** to access services from your telephone service provider does not affect the elapsed time.

#### Elapsed time

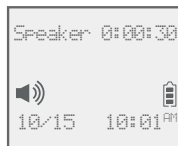
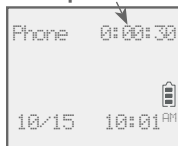

### On hook dialing (predialing)

- Enter the telephone number. Press **MUTE/DELETE** to make corrections when entering the phone number.
- Press **\PHONE/FLASH** or **🔊/SPEAKER** to dial.

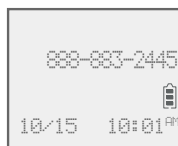

### Answering a call

- Press **\PHONE/FLASH** or **🔊/SPEAKER**.
- OR-**
- Press any dialing key (**0-9**, **TONE ✕** or **#**).

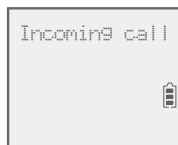

### Ending a call

Press **🔇/OFF/CANCEL** or return the handset to the telephone base or charger.

### Auto off

A call ends automatically when you put the handset in the telephone base or charger.

## Handset operation

**Temporary ringer silencing**

Press **OFF/CANCEL** or **MUTE/DELETE** while the telephone is ringing to silence the ringer temporarily on that handset only. This turns off the ringer without disconnecting the call. The next incoming call rings normally at the preset volume.

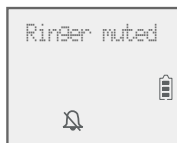

**NOTE:** Each handset rings when there is an incoming call unless the ringer volume is turned off on that handset.

**Speakerphone**

During a call, press **SPEAKER** to switch between handsfree speakerphone and normal handset use. Press **OFF/CANCEL**, or return the handset to the telephone base or charger to hang up.

Elapsed time

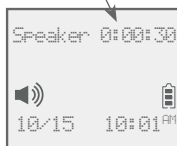

**NOTES:**

- When you use the speakerphone, the key pad of the handset and the **SPEAKER** button are lit.
- The speakerphone uses more power than the normal handset. If the handset battery becomes very low while you are using the speakerphone, the call remains in speakerphone mode until you hang up or the battery becomes depleted.
- After installing a battery into the handset, the screen may show **Low battery**. If you use the speakerphone at this time, the battery may become depleted. Follow the instructions in the **Battery installation and charging** section on pages 8-9.



## Handset operation

### Last number redial

---

Each handset stores the last 10 telephone numbers dialed (up to 30 digits).

#### To view the 10 most recently dialed numbers:

- To display the most recently called number, press **REDIAL/PAUSE**.
- To view up to 10 recently called numbers, press **REDIAL/PAUSE**, then **▼CID** or **▲DIR**, or press **REDIAL/PAUSE** repeatedly.

The handset beeps twice at the end of the list. Press **OFF/CANCEL** to exit.

#### To redial a number:

- To dial the displayed number, press **PHONE/FLASH** or **🔊/SPEAKER**.  
**-OR-**
- Press **PHONE/FLASH** or **🔊/SPEAKER**, then press **REDIAL/PAUSE** repeatedly to view the redial memory. Press **MENU/SELECT** to dial the displayed number.



#### To delete a number:

- While the screen displays the desired number, press **MUTE/DELETE** to delete the number from the redial memory.

# Handset operation

## Equalizer

The equalizer feature on the handset enables you to change the quality of the audio to best suit your hearing.

While on an outside call or intercom call, or listening to a message or announcement, press **EQ** to select the equalizer setting **Treble 1**, **Treble 2**, **Bass** or **Natural** (the default setting). The current setting is shown on the handset screen for two seconds.



### NOTES:

- If you switch the call between the handset and the speakerphone by pressing **SPEAKER**, the audio setting remains unchanged.
- The current equalizer setting remains unchanged until a new setting is selected.



## Options while on calls

### Volume control

While on a call, press **▼CID/VOLUME** to decrease or press **▲DIR/VOLUME** to increase the listening volume. You can set the listening volume to one of six levels.



#### NOTES:

- Handset and speakerphone volume settings are independent.
- When the volume reaches the minimum or maximum setting, you hear two beeps.

▲DIR/VOLUME

▼CID/VOLUME

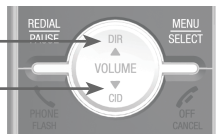

### Call waiting

If you subscribe to call waiting service from your telephone service provider, and someone calls while you are already on a call, you hear two beeps. Press **\PHONE/FLASH** to put your current call on hold and take the new call. Press **\PHONE/FLASH** at any time to switch back and forth between calls.



**NOTE:** Missed call waiting calls are not counted as missed calls.

### Mute

Use the mute function to turn off the microphone. You can hear the caller, but the caller cannot hear you.

#### To mute a call:

- While on a call, press **MUTE/DELETE**. When mute is on, the handset screen shows **Muted** for a few seconds and the **MUTE** icon displays until you turn off mute.



**MUTE/DELETE**

#### To end mute a call:

- Press **MUTE/DELETE** again. When mute is off, **Microphone ON** appears temporarily on the handset screen.



## Options while on calls

**Chain dialing**

Use this feature to initiate a dialing sequence from the numbers in the directory, caller ID log or redial memory while you are on a call.

Chain dialing is useful when you wish to access other numbers (such as bank account numbers or access codes) from the directory, caller ID log or redial list.

**To access the directory while on a call:**

1. Press **MENU/SELECT**.
2. Press **▼CID** or **▲DIR** to scroll to **>Directory** and then press **MENU/SELECT**.
3. Press **▼CID** or **▲DIR** to scroll to the desired number.
4. Press **MENU/SELECT** to dial the number shown.

**To access the caller ID log while on a call:**

1. Press **MENU/SELECT**.
2. Press **▼CID** or **▲DIR** to scroll to **>Caller ID log**, then press **MENU/SELECT**.
3. Press **▼CID** or **▲DIR** to scroll to the desired number.
4. Press **MENU/SELECT** to dial the number shown.

**To access the redial list while on a call:**

1. Press **REDIAL/PAUSE** to show the most recently dialed number.
2. Press **▼CID** or **▲DIR** to scroll to the desired number, or press **REDIAL/PAUSE** repeatedly to show the last 10 recently dialed numbers. Press **MENU/SELECT** to dial the number shown.

**NOTES:**

- You cannot edit a directory entry while on a call. For more details about the directory, see page 38.
- You cannot copy a caller ID entry into the directory while on a call. For more details about the caller ID log, see page 48.
- If you press **REDIAL/PAUSE** while on a call, you can only view the 10 most recently dialed numbers and you cannot erase the entries. For more details about the redial memory, see page 24.
- Press **⏻OFF/CANCEL** to exit redial, directory or caller ID log when on a call.

## Options while on calls

**Temporary tone dialing**

If you have pulse (rotary) service only, you can switch from pulse to touch-tone dialing temporarily during a call. This is useful if you need to send touch-tone signals to access your telephone banking or long distance services.

1. During a call, press **TONE~~X~~**.
2. Use the dialing keys to enter the desired number. The telephone sends touch-tone signals.
3. The telephone automatically returns to pulse dialing after you end the call.

**Blind transfer**

While on an outside call, you can transfer it to a specific handset or any handset.

**To transfer an outside call directly without notifying the desired handset:**

1. During the call, press **MENU/SELECT**.
2. Press **MENU/SELECT** to choose **>Transfer**.
  - If you have a two-handset system, the outside call is put on hold and your handset screen shows **Transferring call....** The other handset rings and its screen shows **Transfer from other handset**.
  - If you have more than two handsets, your screen shows **TRANSFER TO:**. Use the dialing keys to enter a specific handset number (**1-9** for handsets 1-9, **TONE~~X~~** and **0-2** for handsets 10-12, or **TONE~~X~~** and **#** for all handsets), or press **▼CID** or **▲DIR** to scroll to the desired handset and press **MENU/SELECT**. The outside call is put on hold and your handset screen shows **Transferring call...** or **Transferring call to all....** The other handset(s) rings and shows **Transfer from HANDSET X** (X represents the handset number).

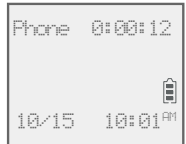

3. To answer the call on the destination handset, press **PHONE/FLASH**, **🔊/SPEAKER**, or any dialing key (**0-9**, **TONE~~X~~**, or **#**). The original handset shows **Call transferred** and goes to idle mode.

**NOTES:**

- To cancel the transfer and return to the external call before the blind transfer call is answered, press **OFF/CANCEL** on your handset.
- If the other handset does not answer the transfer within 30 seconds, the transfer ends and the original handset rings while showing **No response to transfer**. If the original handset does not pick up within 30 seconds, the handset returns to idle mode and the outside call ends.

## Multiple handset use

### Handset locator

---

The handset locator feature is useful if you misplace any handsets.





#### To start the paging tone:

- Press /**HANDSET LOCATOR** on the telephone base to start the paging tone on all handsets for 60 seconds.



**NOTE:** If you press  **OFF/CANCEL** or **MUTE/DELETE** on a handset, the ringer of that handset stops, but the paging to the rest of the handsets continues.



#### To stop the paging tone:

- Press /**PHONE/FLASH**, /**SPEAKER**, or any dialing key (**0-9**, **TONE** , or **#**) on the handset(s).
- OR-
- Press /**HANDSET LOCATOR** on the telephone base.



### Join a call in progress

---

When a handset is already on a call and you would like to join the call, press /**PHONE/FLASH** or /**SPEAKER** on your handset.

Press  **OFF/CANCEL** or place the handset in the telephone base or charger to end the call. The call does not end until all handsets hang up.



**NOTE:** You can use a maximum of four system handsets at the same time on an outside call.

## Intercom

Use the intercom feature for conversations between two handsets. Use a handset to initiate intercom calls and transfer calls.

1. Press **MENU/SELECT** in idle mode to enter the main menu.

Press **▼CID** or **▲DIR** to scroll to **>Intercom**, then press **MENU/SELECT**.

- If you have a two-handset system, your handset screen shows **Calling other handset**.
- If you have more than two handsets, your screen shows **INTERCOM TO:.** Use the dialing keys to enter a specific handset number (**1-9** for handsets 1-9, **TONE X** and **0-2** for handsets 10-12, or **TONE X** and **#** for all handsets), or press **▼CID** or **▲DIR** to scroll to the desired handset and press **MENU/SELECT**. Your handset screen shows **Calling HANDSET X** or **Calling all handsets**.



The other handset(s) rings and shows **Other handset is calling**, **HANDSET X is calling**, or **HANDSET X is calling all** (X represents the handset number).

2. To answer the intercom call, press **PHONE/FLASH**, **🔊/SPEAKER** or any dialing key (**0-9**, **TONE X**, or **#**) on any called handset. Both handsets now show **Intercom**.
3. To end the intercom call, one party presses **OFF/CANCEL**, or places the handset back in the telephone base or charger. The other party hears four beeps. Both handsets display **Intercom ended**.



### NOTES:

- Before the intercom call is answered, you can cancel it by pressing **OFF/CANCEL**.
- If the called party does not answer within 100 seconds or if the handset is in use, on a call or out of range, the calling handset shows **No answer. Try again**.
- Pressing **OFF/CANCEL** or **MUTE/DELETE** temporarily silences the intercom ringer.
- You can only use one pair of handsets to make intercom calls at a time.

## Intercom

### **Answer an incoming call during an intercom call**

---

If you receive an incoming outside call during an intercom call, there is a two-beep call waiting tone.

- To answer the call, press **☎PHONE/FLASH**. The intercom call ends automatically. The party on the intercom call hears 4 beeps. Other system handsets can also answer the incoming call by pressing **☎PHONE/FLASH**.
- To end the intercom call without answering the incoming call, press **🔌OFF/CANCEL**.



## Call transfer using intercom

Use the intercom feature to transfer an outside call to another system handset. You can also share an outside call with another system handset. This feature is available only if you have two or more handsets.



### To transfer or share an outside call using intercom:

1. During the call, press **MENU/SELECT**.
2. Press **▼CID** or **▲DIR** to scroll to **>Intercom** and press **MENU/SELECT**.
3. If you have a two-handset system, your handset screen shows **Calling other handset**.

**-OR-**

If you have more than two handsets, your screen shows **INTERCOM TO:**. Use the dialing keys to enter a specific handset number (**1-9** for handsets 1-9, **TONEX** and **0-2** for handsets 10-12, or **TONEX** and **#** for all handsets), or press **▼CID** or **▲DIR** to scroll to the desired handset and press **MENU/SELECT**. Your handset screen shows **Calling HANDSET X** or **Calling all handsets**.

4. When the destination handset(s) picks up, your handset shows **Intercom** and the outside call is put on hold. You have the following options:
  - You can transfer the call. Press **MENU/SELECT** twice to select **>Transfer** on the calling handset. Your screen shows **Call transferred**. The other handset automatically connects to the outside call.
  - You can let the other handset join you on the outside call in a three-way conversation. Press **MENU/SELECT**. Press **▼CID** or **▲DIR** to highlight **>Share call** on the calling handset, then press **MENU/SELECT**.
  - You can end the intercom call and continue the outside call with your handset. Press **☎PHONE/FLASH** on your handset (the ended intercom call party hears four beeps), or the other person can press **☎OFF/CANCEL** on the other system handset.

## Push-to-talk (PTT)

You can directly broadcast messages to the speakerphone of a group of handsets. Any handset you call can respond by pressing the **PUSH TO TALK** key to begin two-way communication.

- Only one handset can talk at a time. To do so, press and hold **PUSH TO TALK**.
- You must release **PUSH TO TALK**, so another person can respond.
- Only one PTT session can be active at a time.
- While PTT is in use between two handsets, other handsets cannot use the intercom feature but can access the answering system.
- When you attempt to place a PTT call to another handset which is accessing the answering system or on an intercom call or outside call, your handset screen shows **Not available at this time**.

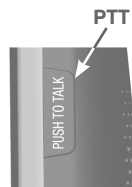

**NOTE:** The PTT function is not available when **QUIET** mode is on.

### Turn incoming PTT on or off

1. Press **PUSH TO TALK** when the handset is not in use. The **PUSH TO TALK** menu displays.
2. Press ▼**CID** or ▲**DIR** to highlight >**PTT On/Off**, then press **MENU/SELECT**.
3. Press ▼**CID** or ▲**DIR** to choose >**On** or >**Off**, then press **MENU/SELECT**.



**NOTE:** The handset screen displays **No Incoming PTT** when PTT is turned off.

## Push-to-talk (PTT)

### PTT call to a single handset

1. There are a few ways to begin a PTT call to a single handset. When the handset is not in use:

- If you have a two-handset system, press and hold **PUSH TO TALK**.
- If you have more than two handsets, press **PUSH TO TALK**. Use the dialing keys to enter the destination handset number.

**-OR-**

Press ▼**CID** or ▲**DIR** to highlight the destination handset number and then press **MENU/SELECT** or **PUSH TO TALK**.



Your handset screen shows **Connecting to HANDSET X...** (X represents the destination handset number) for a few seconds. When the connection is made, both your and the destination handset screens display **Press and hold [PTT] to talk**.

2. Press and hold **PUSH TO TALK** on your handset. A chirp indicates your microphone is on. Speak towards the handset. Your voice broadcasts to the destination handset.

While you are speaking, your handset screen shows **PTT To handset: X**.



3. Release **PUSH TO TALK** after speaking. Both handsets beep once again. After the handsets beep, you can press and hold **PUSH TO TALK** to continue speaking or the destination handset can respond (see **Answer a PTT call** on the page 36).
4. To end the PTT call, press **OFF/CANCEL** or place the handset in the telephone base or charger. The handset screen shows **Push to talk Ended** for a few seconds.

## Push-to-talk (PTT)

### PTT call to a group of handsets

---

When there are multiple handsets registered to the phone system, PTT supports one-to-group calls. PTT supports a maximum of one-to-four calls when two to five handsets are registered, and a maximum of one-to-three calls when six or more handsets are registered. The first four registered handsets will be able to use this feature. Other handsets can only use PTT for one-to-one calls.

#### To call a group of handsets:

1. You have three ways to call a group of handsets.

- Press and hold **PUSH TO TALK** when the handset is not in use until your handset screen shows **Connecting to group....**
- Press **PUSH TO TALK** when the handset is not in use. Press ▼**CID** or ▲**DIR** to choose **Group**. Press **MENU/SELECT** or press and hold **PUSH TO TALK** until your handset screen shows **Connecting to group....**
- Press **PUSH TO TALK** when the handset is not in use. Press **TONEX** and # (pound key). The screen shows **Connecting to group....**

When the connection is made, both the caller and the destination parties hear a beep. The speakerphones on all other handsets automatically activate.

2. You need to press and hold **PUSH TO TALK** when you want to speak. Speak towards the handset. Your voice broadcasts to all eligible handsets.
3. Release **PUSH TO TALK** after speaking.
4. Any handset can reply (see **Answer a PTT call** on page 36).



**NOTE:** After **PUSH TO TALK** is released, the PTT call remains open for a short time. If no one presses **PUSH TO TALK** within 10 seconds, the PTT call ends automatically.

## Push-to-talk (PTT)

### Answer a PTT call

---

You can respond to a PTT call whenever the speakerphone light is off, as described below.

1. When your handset receives a PTT call, the handset beeps and the screen shows **Press and hold [PTT] to talk**.
2. When the other party is speaking, your speakerphone light is on, and your handset shows **PTT From HS X To HS X** (the first **X** represents the initiating handset number, the second **X** represents your handset number; a maximum of four handset numbers appear).
3. When your speakerphone light is off (the screen shows **Press and hold [PTT] to talk**), press and hold **PUSH TO TALK** on your handset. You will hear a chirp. Speak towards the handset.
  - While you are speaking, your handset screen shows **PTT To handset: X** (**X** represents the handset numbers of one or more destination handsets; a maximum of four handset numbers appear).
  - Your voice broadcasts to all destination handsets.

After speaking, release **PUSH TO TALK**. Your handset will beep.

After the beep, if your speakerphone light is off, you can press and hold **PUSH TO TALK** to continue speaking, or the destination handset can respond.

### Change a one-to-one PTT call to an intercom call

---

You can convert a one-to-one PTT session to an intercom call.

1. When your handset screen shows **Press and hold [PTT] to talk**, press **MENU/SELECT**. The screen shows **>Intercom**.
2. Press **MENU/SELECT**. Your handset displays **Calling other handset** or **Calling HANDSET X**. The destination handset screen briefly shows **Push to talk Ended** and then **Other handset is calling** or **HANDSET X is calling**. The destination handset rings.
3. On the destination handset, press **\PHONE/FLASH** or any of the dialing keys (**0-9**, **#**, or **TONE~~X~~**) to answer the intercom call. Both handsets now show **Intercom**.
4. To end the intercom call, press **/OFF/CANCEL** or place the handset in the telephone base or charger. Both screens show **Intercom ended**.

## Push-to-talk (PTT)

### Answer an incoming call during PTT

---

When you receive an incoming outside call during PTT, there is an alert tone.

- During a one-to-one PTT, press **\PHONE/FLASH** on the initiating or destination handset. The PTT call ends automatically and the outside call is answered.
- During a one-to-group PTT, press **\PHONE/FLASH** on the initiating handset. The PTT call ends automatically and the outside call is answered.
- During a one-to-group PTT, press **\PHONE/FLASH** on any one of the destination handsets and that handset answers the outside call. The PTT call continues for the rest of the PTT participants.
- To leave the PTT call without answering the incoming call, press **ⓘOFF/CANCEL**. The telephone continues to ring.

### Make an outgoing call during PTT

---

- During a one-to-one PTT, press **\PHONE/FLASH** to get a dial tone. The PTT call ends automatically.
- During a one-to-group PTT, press **\PHONE/FLASH** on the initiating handset. The PTT call ends automatically and you get a dial tone.
- During a one-to-group PTT, press **\PHONE/FLASH** on any one of the destination handsets and that handset gets a dial tone. The PTT call continues for the rest of the PTT participants.

### End or leave a PTT call

---

For one-to-one PTT calls, both initiating and destination handsets can end PTT. For PTT calls to a group of handsets, the initiating handset can end the PTT call for the group of handsets on the PTT call. If any one of the destination handsets leaves the PTT call, the call continues until all participants or the initiator hangs up.

Press **ⓘOFF/CANCEL** or place the handset in the telephone base or charger. The handset screen shows **Push to talk Ended**.



**NOTE:** After **PUSH TO TALK** is released, the PTT call remains open for a short time. If no one presses **PUSH TO TALK** within 10 seconds, the PTT call ends automatically.

## About the directory

### Shared directory

---

The directory is shared by all handsets. Changes made to the directory from any handset apply to all.



**NOTE:** Only one handset can review the directory at a time. If another handset tries to enter the directory, the screen shows **Not available at this time**.

A rectangular inset image representing a handset screen. It displays a contact entry with the name 'Charlie Johnson' on the first line, the phone number '888-883-2445' on the second line, a double-headed vertical arrow in the center, and a battery status icon in the bottom right corner.

Charlie Johnson  
888-883-2445

### Capacity

---

The directory can store up to 50 entries, with a maximum of 15 alphanumeric characters (including spaces) for names and 30 digits for telephone numbers. A convenient search feature can help you find and dial numbers quickly (page 42).

If you try to save an entry when there are already 50 entries, the screen shows **Directory full**. You cannot store a new number until you delete one.

# Create directory entries

## Create a new directory entry

1. Press **MENU/SELECT** in idle mode to enter the main menu.
2. Press **▼CID** or **▲DIR** to scroll to **>Directory**, then press **MENU/SELECT**.
3. Press **▼CID** or **▲DIR** to highlight **>Add contact**.
4. Press **MENU/SELECT**.
5. Use the dialing keys to enter a telephone number (up to 30 digits) when prompted.
  - Press **▼CID** or **▲DIR** to move the cursor to the left or right.
  - Press **MUTE/DELETE** to erase a digit.
  - Press and hold **MUTE/DELETE** to erase all digits.
  - Press and hold **REDIAL/PAUSE** to enter a three-second dialing pause (a **p** appears).

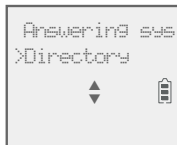

**-OR-**

Copy a number from the redial list by pressing **REDIAL/PAUSE**, then **▼CID** or **▲DIR**, or pressing **REDIAL/PAUSE** repeatedly to locate the number. Press **MENU/SELECT** to copy the number.

6. Press **MENU/SELECT** to move on to the name. The display shows **Number already saved** if the number is already in the directory. You cannot save the same number twice.
7. Use the dialing keys to enter a name (up to 15 characters) when prompted. Each time you press a key, the character on that key appears. Additional key presses produce other characters on that key. See the chart on the next page.
  - Press **▼CID** or **▲DIR** to move the cursor to the left or right.
  - Press **0** to add a space.
  - Press **MUTE/DELETE** to erase a character.
  - Press and hold **MUTE/DELETE** to erase all characters.
  - Press **a>A** to change the next letter to upper or lower case.
8. Press **MENU/SELECT** to store your new directory entry. There is a confirmation tone and the screen shows **Saved**. To change the entry later, see page 44.

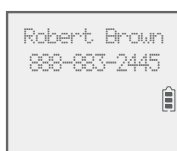
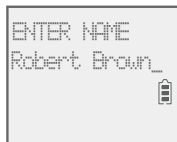

**NOTE:** The first letter of every word is a capital letter. The remaining letters in a word start as lower case letters, as shown in the chart on the next page.



## Create directory entries

Dialing keys	Characters by number of key presses										
	1	2	3	4	5	6	7	8	9	10	11
1	1	.	-	'	(	)	*	#	&	/	,
2	A	B	C	a	b	c	2				
3	D	E	F	d	e	f	3				
4	G	H	I	g	h	i	4				
5	J	K	L	j	k	l	5				
6	M	N	O	m	n	o	6				
7	P	Q	R	S	p	q	r	s	7		
8	T	U	V	t	u	v	8				
9	W	X	Y	Z	w	x	y	z	9		
0	space	0									
*											
#											

### Add a predialed telephone number to the directory

---

You can save a predialed telephone number to the directory.

1. Enter the telephone number when in idle mode.
2. Follow the steps in **Edit a directory entry** on page 44.

## Review the directory

### Review directory entries

---

1. Press **DIR▲** when in idle mode. The summary screen shows briefly and then the first entry in the directory shows.

**-OR-**

Press **MENU/SELECT** when in idle mode, then press ▼**CID** or ▲**DIR** to scroll to **>Directory**. Press **MENU/SELECT** twice.

2. Press ▼**CID** or ▲**DIR** to browse through the directory. Entries appear alphabetically by the first letter in the name.



#### **NOTES:**

- If the telephone number in the directory exceeds 15 digits, <\*> appears in front of the telephone number. Press **TONE X** to move towards the end of the telephone number or press **#** (pound key) to move towards the beginning of the telephone number.
- if there are no directory entries. **Directory empty** appears briefly on the screen, followed by **Add contact?**. If you would like to add a new contact, press **MENU/SELECT** and refer to page 39 for instructions on creating a new directory entry. Otherwise, press **OFF/CANCEL** to cancel.

## Review the directory

### Search by name

---

1. Press **DIR▲** in idle mode to show the first listing in the directory.
2. When an entry appears, press the dialing keys (**0-9**) to start a name search. The directory shows the first name beginning with the first letter associated with the dialing key, if there is an entry in the directory beginning with that letter. Press **▼CID** or **▲DIR** to scroll through the directory.
3. To see other names starting with the letters on the same dialing key, keep pressing the key. The names appear in alphabetical order.

For example, if you have the names **Jennifer**, **Jessie**, **Kevin** and **Linda** in your directory:

- If you press **5 (JKL)** once, you see **Jennifer**. Press **▼CID** and you see **Jessie**.
- If you press **5 (JKL)** twice, you see **Kevin**.
- If you press **5 (JKL)** three times, you see **Linda**.
- If you press **5 (JKL)** four times, you see **5** and then the directory entry beginning with 5 or the next closest entry after 5.
- If you press **5 (JKL)** five times, you see **Jennifer** again.



#### NOTES:

- If there is no name matching the first letter of the key you press, the directory shows a name matching the following letters of the key.
- If you press a key (**0-9**) and no name starts with any of the letters on that key, the directory shows the entry matching the next letter in the directory.

## Dial, delete or edit directory entries

To dial, delete or edit a directory entry (name and number), the entry must be displayed on the handset. Use **Review the directory** (page 41) to show an entry.

### Display dial

---

To dial a displayed number from the directory, press **\PHONE/FLASH** or **🔊/SPEAKER**.

### Delete a directory entry

---

To delete the displayed directory entry, press **MUTE/DELETE**. Press **MENU/SELECT** to confirm. There is a confirmation tone and the screen shows **Contact deleted**. You cannot retrieve a deleted entry.

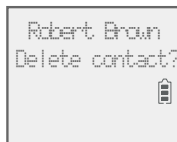

# Dial, delete or edit directory entries

## Edit a directory entry

1. When a directory entry displays, press **MENU/SELECT**. The screen shows **EDIT NUMBER** along with the phone number to be edited. If you only want to edit the name, skip to Step 3.



2. To edit the number:

- Press the dialing keys to add digits.
- Press **▼CID** or **▲DIR** to move the cursor to the left or right.
- Press **MUTE/DELETE** to erase a digit.
- Press and hold **MUTE/DELETE** to erase all digits.
- Press and hold **REDIAL/PAUSE** to add a three-second pause, if desired.



3. Press **MENU/SELECT** to save the number. The screen shows **EDIT NAME** along with the name to be edited.

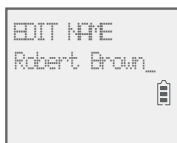

4. To edit the name:

- Press the dialing keys to add characters (page 40).
- Press **▼CID** or **▲DIR** to move the cursor to the left or right.
- Press **MUTE/DELETE** to erase a character.
- Press and hold **MUTE/DELETE** to erase all characters.
- Press **a>A** to change the next letter to upper or lower case.



5. Press **MENU/SELECT**. There is a confirmation tone and the screen shows **Saved**.





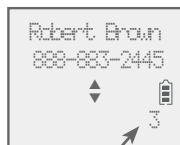



# Speed dial

The telephone system has 9 speed dial locations (**2-9, 0**) and a voicemail access location  **1** where you can store the telephone numbers you wish to dial more quickly. You can store up to 30 digits in each location. Speed dial assignments can only be selected from the existing directory entries. The voicemail access number must be manually entered. In the directory, speed dial locations are indicated by their number on the bottom right hand corner of the entry.



Speed dial location

## Assign a speed dial number

1. When the telephone is idle, press **MENU/SELECT**.
2. Press  **CID** or  **DIR** to scroll to **>Directory**. Press **MENU/SELECT**.
3. Press  **CID** or  **DIR** to scroll to **>Speed dial**. Press **MENU/SELECT**.
4. Press  **CID** or  **DIR** to choose your desired speed dial location (**2-9, 0**), then press **MENU/SELECT**. The screen briefly shows **Copy from Directory...** and then enters your directory list.
5. Press  **CID** or  **DIR** to scroll to the phone number you wish to assign to the selected speed dial location.
6. Press **MENU/SELECT** to save the setting and return to the previous menu. There is a confirmation tone.

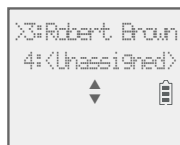

## Reassign a speed dial number

1. When the telephone is idle, press **MENU/SELECT**.
2. Press ▼CID or ▲DIR to scroll to >Directory. Press **MENU/SELECT**.
3. Press ▼CID or ▲DIR to scroll to >Speed dial. Press **MENU/SELECT**.
4. Press ▼CID or ▲DIR to choose the location (2-9, 0) you wish to reassign, then press **MENU/SELECT** to show the directory entry.
5. Press **MENU/SELECT** again.
6. Scroll to >Change SD and then press **MENU/SELECT**. The screen briefly shows **Copy from Directory...** and then enters your directory list.
7. Press ▼CID or ▲DIR to scroll to the phone number you wish to reassign to the selected speed dial location.
8. Press **MENU/SELECT** to save the setting and return to the previous menu. There is a confirmation tone.



## Delete a speed dial number

1. When the telephone is idle, press **MENU/SELECT**.
2. Press ▼CID or ▲DIR to scroll to >Directory. Press **MENU/SELECT**.
3. Press ▼CID or ▲DIR to scroll to >Speed dial. Press **MENU/SELECT**.
4. Press ▼CID or ▲DIR to scroll to the location you wish to delete the speed dial number from, then press **MENU/SELECT** to show the directory entry.
5. Press **MENU/SELECT** again.
6. Scroll to >Clear SD and then press **MENU/SELECT** to delete the displayed speed dial number. There is a confirmation tone and the screen shows **Speed dial empty** before returning to the previous menu.



## Speed dial

### Assign your speed dial voicemail number

---

See the **Set speed dial voicemail number** section on page 16 for instructions on assigning your speed dial voicemail number.

### Make a call using speed dial

---

When in idle mode, press and hold the dialing key (**2-9, 0**) corresponding to the assigned location you wish to call.

**-OR-**

1. Press **MENU/SELECT** when in idle mode.
2. Press ▼**CID** or ▲**DIR** to scroll to >**Directory**, then press **MENU/SELECT**.
3. Press ▼**CID** or ▲**DIR** to scroll to >**Speed dial**, then press **MENU/SELECT**.
4. Press ▼**CID** or ▲**DIR** to scroll to the desired location and then press  
☎**PHONE/FLASH** or 🔊**/SPEAKER**.

### Check your voicemail using speed dial

---

Press and hold the 📧 **1** key on your handset to dial your voicemail number.



## About caller ID

This product supports caller ID services offered by most telephone service providers. Caller ID allows you to see the name, number, date and time of calls. The available caller ID information will appear after the first or second ring.

### Information about caller ID with call waiting

---

Caller ID with call waiting lets you see the name and telephone number of the caller before answering the call, even while on another call.

It might be necessary to change your telephone service to use this feature. Contact your telephone service provider if:

- You have both caller ID and call waiting, but as separate services (you might need to combine these services).
- You have only caller ID service, or only call waiting service.
- You don't subscribe to caller ID or call waiting services.

There are fees for caller ID services. In addition, services may not be available in all areas.

This product can provide information only if both you and the caller are in areas offering caller ID service and if both telephone service providers use compatible equipment. The time and date, along with the call information, are from the telephone service provider.

Caller ID information might not be available for every incoming call. Callers may intentionally block their names and/or telephone numbers. To view caller ID log entries with numbers between 16 and 24 digits, you must save the entry to the directory (see page 52).



**NOTE:** You can use this product with regular caller ID service, or you can use this product's other features without subscribing to caller ID or combined caller ID with call waiting service.



# Caller ID log

## How the caller ID log works

The telephone stores caller ID information about the last 50 incoming calls in the telephone base. Entries are stored in reverse chronological order. The phone deletes the oldest entry when the log is full to make room for new calls. This information is common to all handsets, so changes made using any handset are reflected in all other handsets. If you answer a call before the information appears on the screen, it does not show in the caller ID log.



**NOTE:** Each entry may have up to 24 digits for the phone number and 15 characters for the name.

## Missed (new) call indicator

When a handset is in idle mode and has new or missed calls, its screen shows **XX Missed calls**.

All new or missed entries are counted as missed calls. Each time you review a new caller ID log entry (indicated by **NEW** on the handset screen), the number of missed calls decreases by one.

If you do not want to review the missed calls one by one, but still want to keep them in the caller ID log, you can press and hold **OFF/CANCEL** for four seconds when the handset is idle. All the entries in the caller ID log become old (reviewed already), and the missed calls message goes away.

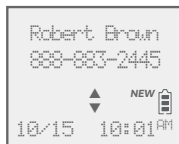
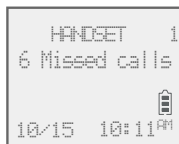

# Caller ID operation

## Memory match

If the incoming telephone number matches the last seven digits of a telephone number in your directory, the name that appears on the screen matches the corresponding name in your directory.

For example, if Christine Smith calls, her name appears as **Chris** if this is how you entered it into your directory.



**NOTE:** The number shown in the caller ID log will be in the format sent by the telephone service provider. The telephone service provider usually delivers 10-digit phone numbers (area code plus telephone number). If the telephone number of the caller does not match a number in your directory, the name will appear as it is delivered by the telephone service provider.



## Review the caller ID log

Review the caller ID log to find out who called, to return the call, or to copy the caller's name and number into your directory. **Caller ID log empty** appears if there are no records in the caller ID log.

1. When a handset is in idle mode, press **▼CID** to review the caller ID log in reverse chronological order starting with the most recent call.

**-OR-**

Review the caller ID log by pressing **MENU/SELECT**.

Press **▼CID** or **▲DIR** to scroll to **>Caller ID log**, then press **MENU/SELECT** twice to select **>Review**.

2. Press **▼CID** or **▲DIR** to scroll through the list.
3. Press **↵OFF/CANCEL** to exit the caller ID log.

You hear a double beep when the list reaches the beginning or end of the caller ID log.



**NOTE:** Only one handset can review the caller ID log at a time. If another handset tries to enter the directory or caller ID log, it shows **Not available at this time**.



**▼CID**

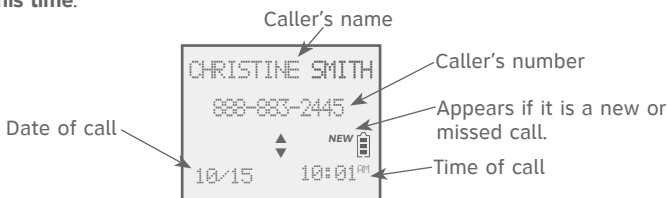

# Caller ID operation

## View dialing options

Although the incoming caller ID log entries have 10 digits (the area code plus the seven-digit number), in some areas, you might need to dial only the 7 digits, 1 plus the seven digits, or 1 plus the area code plus the seven digits. You can change and store the number of digits that you dial in the caller ID log.

While reviewing the caller ID log, press **#** (pound key) repeatedly to show different dialing options for local and long distance numbers before dialing or saving the telephone number in the directory.

883-2445  
1-883-2445  
888-883-2445  
1-888-883-2445

Press **#**

Press **1** repeatedly if you need to add or remove 1 in front of the telephone number before dialing or saving it in the directory.

883-2445  
1-883-2445

Press **1**

888-883-2445  
1-888-883-2445

When the number is in the correct format for dialing, press **\PHONE/FLASH** or **📞/SPEAKER** to call the number.

To save the number to the directory, see **Save a caller ID log entry to the directory** on the next page.

## Dial a caller ID log entry

1. When in the caller ID log, press **▼CID** or **DIR▲** to browse.
2. Press **\PHONE/FLASH** or **📞/SPEAKER** to dial the displayed entry.

## Delete caller ID log entries

### To delete an entry:

- Press **MUTE/DELETE** to delete the shown entry.

### To delete all entries:

1. Press **MENU/SELECT** when in idle mode.
2. Press **▼CID** or **▲DIR** to scroll to **>Caller ID log**, then press **MENU/SELECT**.
3. Press **▼CID** or **▲DIR** to scroll to **>Del all calls**, then press **MENU/SELECT**.
4. When the screen shows **Delete all calls?**, press **MENU/SELECT** to confirm. There is a confirmation tone and the screen returns to the previous menu.

Review  
>Del all calls  
⬆ ⬇ 🔋

## Caller ID operation

### Save a caller ID log entry to the directory

---

1. When in the caller ID log, press ▼CID or ▲DIR to browse.
2. Press **MENU/SELECT** to select an entry. The screen displays **EDIT NUMBER**.
3. Use the dialing keys to edit the number.
  - Press ▼CID or ▲DIR to move the cursor to the left or right.
  - Press **MUTE/DELETE** to backspace and erase a digit.
  - Press and hold **MUTE/DELETE** to erase the entire entry.
  - Press and hold **REDIAL/PAUSE** to insert a three-second dialing pause (a **p** appears).
4. Press **MENU/SELECT** to move to the name. The screen displays **EDIT NAME**. Use the dialing keys (page 40) to edit the name.
  - Press ▼CID or ▲DIR to move the cursor to the left or right.
  - Press **MUTE/DELETE** to erase a character.
  - Press and hold **MUTE/DELETE** to erase all characters.
  - Press **#** (pound key) to move the last word to the front. For example, **Johnson Charlie** becomes **Charlie Johnson** when you press **#**.
  - Press **a>A** to change the next letter to upper or lower case.
5. Press **MENU/SELECT** when done. The handset shows **Saved**.



#### NOTES:

- You might need to change how a caller ID number is dialed if the entry does not appear in the correct format. Caller ID numbers might appear with an area code that is not necessary for local calls, or without a 1 that is necessary for long distance calls (see **View dialing options** on page 51).
- If the name you received from the telephone service provider is all in capital letters, the first letter of every word remains a capital letter, while other letters become lower case. However, the next letter after the prefix "Mac", "Mc", or "O", is kept as a capital letter. For example, the "D" in "MacDonald" is kept as a capital letter.
- If the telephone number from the caller ID information has already been saved in the directory under a different name, the new name will overwrite the old one.

## Reasons for missing caller ID information

There are occasions when other information or no information shows for various reasons:

On-screen message	Reason
PRIVATE NUMBER	The caller prefers not to show the phone number.
PRIVATE NAME	The caller prefers not to show the name.
PRIVATE CALLER	The caller prefers not to show the phone number and name.
UNKNOWN NUMBER	Your telephone service provider cannot determine the caller's number.
UNKNOWN NAME	Your telephone service provider cannot determine the caller's name.
UNKNOWN CALLER	Your telephone service provider cannot determine the caller's name and telephone number. Calls from other countries may also generate this message.

## Answering system settings

Use the answering system menu of a system handset to set up the announcement message, turn on or off the answering system or message alert tone, activate call screening, or change the number of rings, message recording time, or remote access code. If you turn off the answering system and you change any setting in the answering system setup menu, the answering machine automatically turns on again.



1. When the handset is in idle mode, press **MENU/SELECT** to enter the main menu.
2. Press **▼CID** or **▲DIR** to scroll to **>Answering sys**, then press **MENU/SELECT**.

### Announcement

Your outgoing announcement plays when calls are answered by the answering system.

The telephone has a default outgoing announcement, *"Hello. Please leave a message after the tone."* You can use this announcement, or record your own.

You can record an announcement up to 90 seconds. The system does not record any announcement shorter than two seconds.

#### To play your current outgoing announcement:

1. When the handset is in idle mode, press **MENU/SELECT** to enter the main menu.
2. Press **▼CID** or **▲DIR** to scroll to **>Answering sys**, then press **MENU/SELECT**.
3. Press **MENU/SELECT** again to select **>Announcement**.
4. Press **▼CID** or **▲DIR** to scroll to **>Play annc** and press **MENU/SELECT** play the announcement.



#### To record a new outgoing announcement:

1. When the handset is in idle mode, press **MENU/SELECT** to enter the main menu.
2. Press **▼CID** or **▲DIR** to scroll to **>Answering sys**, then press **MENU/SELECT**.
3. Press **MENU/SELECT** again to select **>Announcement**.



## Answering system settings

4. Press **MENU/SELECT** to select **>Record annc.** The system announces, *"Record after the tone. Press 5 when you are done."*
5. Facing the handset, record your announcement and press **5** to end recording. Your recorded announcement plays.

To listen to the recorded announcement again, wait after playback completed, then scroll to **>Play annc** and press **MENU/SELECT**.

### To reset your outgoing announcement:

1. When the handset is in idle mode, press **MENU/SELECT** to enter the main menu.
2. Press **▼CID** or **▲DIR** to scroll to **>Answering sys**, then press **MENU/SELECT**.
3. Press **MENU/SELECT** again to select **>Announcement**.
4. Press **▼CID** or **▲DIR** to scroll to **>Reset annc** and press **MENU/SELECT**. The screen prompts **Reset to default annc?**. Press **MENU/SELECT** to confirm. The screen shows **Annc. reset to default** before returning to the previous menu.

**-OR-**

Press **▼CID** or **▲DIR** to scroll to **>Play annc** and play the announcement. While the announcement is playing, press **MUTE/DELETE** to reset the announcement. The system announces *"Announcement deleted"* and the screen shows **Annc. Deleted** before returning to the previous menu.

When your announcement is reset, the system answers calls with the default announcement described on the previous page. You cannot delete the default announcement.



# Answering system settings

## Answer on/off

By default, the answering system is on and ready to record messages. You can turn the answering system off, but if you do so, the answering system does not answer calls or record incoming messages.

### To turn the answering system on or off:

#### Using the telephone base:

- Press **⏻/ANSWER ON/OFF** to turn the answering system on or off. If the answering system is turned on, it announces, *"Calls will be answered."* If the answering system is turned off, it announces, *"Calls will not be answered."*

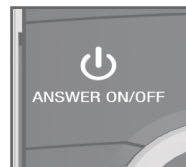

#### Using a handset:

- When the handset is in idle mode, press **MENU/SELECT** to enter the main menu.
- Press **▼CID** or **▲DIR** to scroll to **>Answering sys**, then press **MENU/SELECT**.
- Press **▼CID** or **▲DIR** to scroll to **>Answer ON/OFF**, then press **MENU/SELECT**.
- Press **▼CID** or **▲DIR** to highlight **>On** or **>Off**, then press **MENU/SELECT** to save the setting. You hear a confirmation tone. Press **⏻OFF/CANCEL** to cancel.

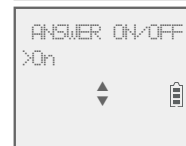

When the answering system is on, the handset screen shows **ANS ON**.

# Answering system settings

## Call screening

Use this feature to choose whether incoming messages can be heard over the telephone base speaker when they are being recorded. If you turn call screening on, you hear the incoming message. While monitoring an incoming message, you can answer the call by pressing **PHONE/FLASH** or **⏮/SPEAKER** on the handset.

### To change the setting:

1. When the handset is in idle mode, press **MENU/SELECT** to enter the main menu.
2. Press **▼CID** or **▲DIR** to scroll to **>Answering sys**, then press **MENU/SELECT**.
3. Press **▼CID** or **▲DIR** to scroll to **>Ans sys setup**, then press **MENU/SELECT**.
4. Press **MENU/SELECT** to select **>Call screening**.
5. Press **▼CID** or **▲DIR** to choose **>On** or **>Off**.
6. Press **MENU/SELECT** to save the setting. You hear a confirmation tone. Press **⏮/OFF/CANCEL** to cancel.



**NOTE:** For more information on call screening, see page 62.

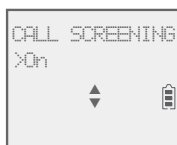
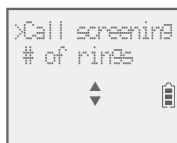

## Number of rings

You can set the answering system to answer an incoming call after two, three, four, five, or six rings. You can also select toll saver, which is explained below. By default, the answering system answers an incoming call after four rings.

### To set the number of rings:

1. When the handset is in idle mode, press **MENU/SELECT** to enter the main menu.
2. Press **▼CID** or **▲DIR** to scroll to **>Answering sys**, then press **MENU/SELECT**.
3. Press **▼CID** or **▲DIR** to scroll to **>Ans sys setup**, then press **MENU/SELECT**.
4. Press **▼CID** or **▲DIR** to scroll to **># of rings**, then press **MENU/SELECT**.

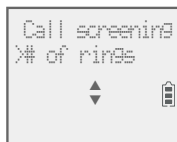

## Answering system settings

5. Press ▼**CID** or ▲**DIR** to scroll and choose among **2, 3, 4, 5, 6** or **Toll saver**.
  - Toll saver - the answering system answers a call after two rings if you have new messages, and after four rings when there are no new messages. This feature allows you to check for new messages and avoid paying long distance charges when calling from out of your local area.
6. Press **MENU/SELECT** to save the setting. You hear a confirmation tone. Press  **OFF/CANCEL** to cancel.



### NOTES:

- If you subscribe to voicemail service through your telephone service provider, see **Answering system and voicemail indicators** on page 60.
- If you set the number of rings for the answering system as two or three rings, the caller ID announce feature may not have enough time to announce the caller's full information.

## Remote access code

To access your answering system remotely from any touch-tone phone, you need to enter a two-digit number (00-99). By default, the remote access code is 19.

### To change the remote access code:

1. When the handset is in idle mode, press **MENU/SELECT** to enter the main menu.
2. Press ▼**CID** or ▲**DIR** to scroll to **>Answering sys**, then press **MENU/SELECT**.
3. Press ▼**CID** or ▲**DIR** to scroll to **>Ans sys setup**, then press **MENU/SELECT**.
4. Press ▼**CID** or ▲**DIR** to scroll to **>Remote code**, then press **MENU/SELECT**.
5. Use the dialing keys to enter a two-digit number. Use **MUTE/DELETE** to backspace and delete a digit.
6. Press **MENU/SELECT** to save the setting. You hear a confirmation tone. Press  **OFF/CANCEL** to cancel.

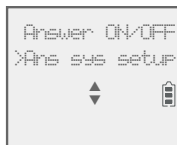

# Answering system settings

## Message alert tone

When the message alert tone is set to **On**, and there is at least one new message, the telephone base beeps every 10 seconds. By default, the message alert tone is set to off.

There is no audible alert at the handset.

### To change the setting:

1. When the handset is in idle mode, press **MENU/SELECT** to enter the main menu.
2. Press **▼CID** or **▲DIR** to scroll to **>Answering sys**, then press **MENU/SELECT**.
3. Press **▼CID** or **▲DIR** to scroll to **>Ans sys setup**, then press **MENU/SELECT**.
4. Press **▼CID** or **▲DIR** to scroll to **>Msg alert tone**, then press **MENU/SELECT**.
5. Press **▼CID** or **▲DIR** to choose **>On** or **>Off**.
6. Press **MENU/SELECT** to save the setting. You hear a confirmation tone. Press **⏏OFF/CANCEL** to cancel.

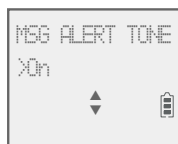

### NOTES:

- The message alert tone beeps only if all the following conditions are met:
  - Answering system is on.
  - Message alert tone setting is on.
  - There are new messages.
- To temporarily turn off the message alert tone, see page 63.

## Message recording time

You can set the recording time allowed for incoming messages. The message length is three minutes by default.

### To change the setting:

1. When the handset is in idle mode, press **MENU/SELECT** to enter the main menu.
2. Press **▼CID** or **▲DIR** to scroll to **>Answering sys**, then press **MENU/SELECT**.
3. Press **▼CID** or **▲DIR** to scroll to **>Ans sys setup**, then press **MENU/SELECT**.
4. Press **▼CID** or **▲DIR** to scroll to **>Recording time**, then press **MENU/SELECT**.
5. Press **▼CID** or **▲DIR** to choose **>3 minutes**, **>2 minutes**, or **>1 minute**, then press **MENU/SELECT** to save the setting. You hear a confirmation tone. Press **⏏OFF/CANCEL** to cancel.

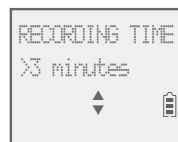

## About the answering system

### Answering system and voicemail indicators

Your telephone has separate indicators for two different types of voice messages: those left on its built-in digital answering system and those left at your telephone service provider's voicemail (fees may apply). Your telephone's built-in digital answering system messages and voicemail messages are separate. Each alerts you to new messages differently.

- If **OO** and **XX New messages** show on the handset and the message window on the telephone base flashes, there are new messages in the built-in answering system. To listen to messages recorded on your digital answering system, press **▶/■/PLAY/STOP** on the telephone base (page 64).
- If **✉** and **New voicemail** display on the handset, your telephone service provider is indicating that it has new voicemail for you. To listen to your voicemail, dial an access number provided by your telephone service provider, followed by a security code or PIN.



Some telephone service providers bundle or combine multiple services like voicemail and call waiting, so you may not be aware that you have voicemail. To check what services you have and how to access them, contact your telephone service provider.

To use your voicemail service rather than the answering system, turn off the answering system. To use the answering system rather than your voicemail service, contact your telephone service provider to deactivate your voicemail service.



**NOTE:** After reviewing all new messages, the number of old messages appears on the message window.

## About the answering system

### Using the answering machine and voicemail together

---

You can also use your telephone answering system and voicemail together by setting your built-in answering system to answer before voicemail answers, as described below. To learn how to program your voicemail settings, contact your telephone service provider. If you are on a call, or if the answering system is busy recording a message and you receive another call, the second caller can leave a voicemail message.

Set your answering system to answer calls at least two rings earlier than your voicemail is set to answer. For example, if your voicemail answers after six rings, set your answering system to answer after four rings. Some voicemail providers may program the delay before answering calls in seconds instead of rings. In this case, allow 6 seconds per ring when determining the appropriate setting.

### Message capacity

---

The answering system can record up to 99 messages, depending on the length of each message. Individual messages can be up to three minutes, and the maximum recording time is approximately 11 minutes. The actual recording time depends on individual message characteristics. Messages remain available for replay until you delete them.

When there are new messages (including memos) on the answering system, the number of messages stored flashes in the message counter.

If the answering system has less than three minutes of recording time left, it announces, *"Less than three minutes to record,"* before message playback at the handset or the telephone base. **Rec mem low** displays on the handset screen in idle mode. When you turn on the answering system at the telephone base, it announces, *"Calls will be answered. Less than three minutes to record."*

If the memory is full, the answering system announces, *"Memory is full,"* before message playback. The handset screen displays **Rec mem full** in idle mode and the number of messages and **F** flash alternately in the message counter at the telephone base. Once the memory is full, you cannot turn the answering system back on if it has been turned off, nor can you record new messages until old ones have been deleted. **Memory full** displays if you want to turn on the answering system on the handset but there is no memory.

## About the answering system

### Voice prompts

---

The system provides voice prompts to guide you through the setup procedures at the telephone base, message playback, remote access and recording outgoing announcements.

### Call screening at the telephone base

---

If the answering system and call screening are on, the announcement and the incoming message broadcast at the telephone base when a call is answered by the answering system.

You can turn call screening on or off using the handset (see page 57). When call screening is off, you can temporarily turn on call screening by pressing **▲/VOL+** on the telephone base. Call screening will be off for the next incoming call.

If call screening is on and you want to silence the telephone base while it is recording messages, press **▶/■/PLAY/STOP**.

### Call screening at the handset

---

If the answering system is on and has answered an incoming call, the announcement and the incoming message broadcast at the telephone base. While a message is being recorded, the handset shows **To screen call, press [SELECT]**. Press **MENU/SELECT** to screen the call.

### Call intercept

---

While screening a call, you can stop recording and speak to the caller by pressing **☎PHONE/FLASH** on the handset.

### Base ringer

---

Press **▼/VOL-** or **▲/VOL+** on the telephone base to adjust the ringer volume when the telephone is not in use.

You hear a sample of the ringer while adjusting the volume. The telephone base announces, *"Base ringer is off,"* when you set the volume to **0**.

## About the answering system

### **Temporarily turning off the message alert tone**

---

If the new message alert tone is turned on, the telephone base beeps every 10 seconds when there are new or missed messages. Pressing any telephone base key (except /**HANDSET LOCATOR**) temporarily silences the message alert tone.

If you press **X/DELETE** when in idle mode to temporarily turn off the message alert tone, there is a voice prompt directing you to press **X/DELETE** again to delete all old messages. The message alert tone is temporarily off. Only press **X/DELETE** a second time if you wish to erase all old messages in your answering system.

The message alert tone resumes when you receive another message.



## Message playback

If you have new messages, you hear only the new messages in chronological order. If there are no new messages, the system plays back all the messages (in chronological order).

When playback begins, the total number of messages is announced. Before each message, you hear the day and time of the recording. If the date and time are not set, you hear, *"Time and date not set,"* before playback. After the last message, you hear, *"End of messages."* If the recording time is less than three minutes, you hear, *"Less than three minutes to record,"* (see **Message capacity** on page 61).

### To listen to messages at the telephone base:

Press ►/■/PLAY/STOP on the telephone base to listen to the messages. The system announces the number of messages, then begins playback. Press ►/■/PLAY/STOP again to end the message playback.

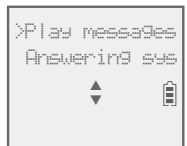

### To listen to messages on a cordless handset:

1. When the handset is in idle mode, press **MENU/SELECT** to enter the main menu.
2. Press **MENU/SELECT** again to select **>Play messages**.
  - If there are new and old messages, press ▼CID or ▲DIR to select **>Play new msgs** or **>Play old msgs**, then press **MENU/SELECT**.
  - If there are only new or only old messages, they will play automatically.



The system announces the number of messages, then begins playback. The message sequence is shown on the handset screen. If there are no recorded messages, the handset screen shows **No message** and you hear, *"You have no message."*



# Message playback

## Options during playback

---

When a message is playing, you can adjust the playback volume, skip, repeat or delete the message.

### When messages are playing on the telephone base:

- Press **▼/VOL-** or **▲/VOL+** to adjust the message playback volume.
- Press **▶/SKIP** to skip to the next message.
- Press **◀/REPEAT** to repeat the message. Press twice to hear the previous message.
- Press **X/DELETE** to delete the message.
- Press **▶/■/PLAY/STOP** to stop the playback.

### When messages are playing on the handset:

- Press **\PHONE/FLASH** to stop playback. The screen shows **Call back?**, then press **MENU/SELECT**, **\PHONE/FLASH**, or **📞/SPEAKER** to call back the caller if the caller's number is available. If the dialing format used is not correct, then use the following option to choose the correct dialing format before calling back the caller.
- Press **MENU/SELECT** to pause playback and show the caller ID information if available. From here, you can press **🔇/OFF/CANCEL** to resume playback, press **#** to show different dialing options (page 51), or press **\PHONE/FLASH** or **📞/SPEAKER** to call back the caller. If you do not call back within 10 seconds, message playback resumes automatically.
- Press **▼CID/VOLUME** or **▲DIR/VOLUME** to adjust the message playback volume.
- Press **EQ**  to adjust the message playback audio quality.
- Press **6** to skip to the next message.
- Press **4** to repeat the message. Press twice to hear the previous message.
- Press **MUTE/DELETE** to delete the message.
- Press **5** to stop the playback.
- Press **📞/SPEAKER** to switch between speakerphone mode and handset mode.



**NOTE:** The equalizer stays on the same settings until you change it by pressing **EQ** .

# Message playback

## Delete all old messages

You can only delete old (reviewed) messages. You cannot delete new messages until you review them. You cannot retrieve deleted messages.

### To delete all old messages on the telephone base:

1. When the telephone is idle, press **X/DELETE**. The system announces, *"To delete all old messages, press **DELETE** again."*
2. Press **X/DELETE** again. The system announces, *"All old messages deleted."*

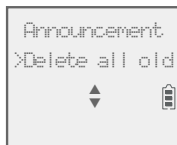

### To delete all old messages on the handset:

1. Press **MENU/SELECT** when in idle mode to enter the main menu.
2. Press **▼CID** or **▲DIR** to scroll to **>Answering sys.** Press **MENU/SELECT**.
3. Press **▼CID** or **▲DIR** to highlight **Delete all old**, then press **MENU/SELECT**. The screen shows **Delete all old messages?**.
4. Press **MENU/SELECT** again to confirm. The screen displays **Deleting...** and then **All old msgs deleted!**. There is a confirmation tone.



## Recording and playing memos

Memos are your own recorded messages used as reminders for yourself or others using the same answering system. Play and delete them in the same way as incoming messages.

### Record a memo

1. When the handset is in idle mode, press **MENU/SELECT** to enter the main menu.
2. Press **▼CID** or **▲DIR** to scroll to **>Answering sys.** Press **MENU/SELECT**.
3. Press **▼CID** or **▲DIR** to highlight **Record memo**, then press **MENU/SELECT**. The system announces, *"Record after the tone. Press 5 when you are done."* You can record a memo for up to four minutes.
4. Speak facing the handset to record a memo.
5. Press **5** to stop recording. The system announces, *"Recorded."* The system does not save memos shorter than two seconds.



### Play back a memo

Play memos the same way as messages. See **Message playback** on page 64.

## Base message counter displays

The base message counter shows the total number of answering system messages. See the following table for other message counter displays.

### Message counter displays

0	No messages.
0 (flashing)	You need to set the clock (page 13).
1-99	Total number of old messages and memos, or message number currently playing during old message playback.
1-99 (flashing)	Total number of messages and memos. The number flashes when there are new or missed messages. After a power failure, the number in the message counter flashes to indicate that you need to set the clock.
1-99 & F (alternating)	Memory is full. You must delete some messages before recording new messages.
....	The system is answering a call, recording a message or memo, or is being reached remotely. The telephone line is in use.
0-6	Shows for two seconds while adjusting the telephone base ringer volume.
1-8	Shows for two seconds while adjusting the telephone base speaker volume.

## Answering system Remote access

You can reach your answering system remotely by dialing your home telephone number from any touch-tone telephone.

### To remotely reach your answering system:

1. Dial your telephone number from any touch-tone telephone.
2. When the system answers, enter the two-digit remote access code (**19** is the default code. See page 58 to change it).
  - The system automatically announces the number of new or old messages (if any), and then begins to play them.
3. You can also enter the following remote commands:

#### Remote commands

<b>1</b>	Press to listen to all messages.
<b>2</b>	Press to listen to new messages only.
<b>3</b>	Press to delete the current message (during playback).
<b>33</b>	Press twice to delete all old messages.
<b>4</b>	Press to repeat the current message (during playback).
<b>44</b>	Press twice to listen to the previous message.
<b>5</b>	Press to stop any operation (including recording).
<b>*5</b>	Press to listen to a list of remote commands.
<b>6</b>	Press to skip to the next message (during playback).
<b>*7</b>	Press to record a new announcement.
<b>8</b>	Press to end remote access (the call will be terminated).
<b>0</b>	Press to turn the answering system on or off.

4. Hang up or press **8** to end the call.

## Remote access

Cut out and carry the remote access wallet card at the back of this user's manual for quick reference.



### **NOTES:**

- If you do not enter a valid remote access code, the system answers the call automatically.
- If you pause for more than four seconds during remote access, you hear a help menu listing all features and commands. If there is no command for another 20 seconds, the call ends automatically.
- If the memory is full, the answering system answers after 10 rings and announces, *"Memory is full. Enter the remote access code."* Enter your remote access code to access the messages and announcements.

## Adding and registering handsets/headsets

Your telephone can support up to 12 DECT 6.0 cordless handsets (AT&T model CL80143/CL80173/CL80183/CL80193, sold separately) or up to 10 cordless handsets and 2 cordless headsets (sold separately). Visit

**[www.telephones.att.com/headsets](http://www.telephones.att.com/headsets)** for a list of compatible DECT 6.0 cordless headsets. Each new handset or headset must be registered to the telephone base before use. You must register each handset or headset separately.

To register a cordless headset to this telephone system, please refer to the user's manual of the cordless headset for more details. To register a cordless handset, see below.

The handsets provided within your product box are already registered as **HANDSET 1**, and so forth. Additional handsets are assigned numbers in the sequential order they are registered (up to **HANDSET 12**).

### Register a handset to your telephone base

1. Before you begin registration, make sure the handset is out of the telephone base or charger and shows **To register HS, see manual.**
2. Put the handset you wish to register on the telephone base cradle.
3. The screen shows **Registering... Please wait** and the **IN USE** light turns on. It takes up to 90 seconds to complete registration. **HANDSET X Registered** appears on the screen, with **HANDSET X** being the handset number (**1-12**). The handset beeps and the **IN USE** light turns off. The handset is now registered with the telephone base.

To register HS,  
see manual.



Registering...  
Please wait



HANDSET X  
Registered



For registration, put the handset on the telephone base, not the handset charger.



## Adding and registering handsets/headsets

If registration fails, the system will automatically try to register again. If registration fails after the third try, **Registration failed** appears on the screen for a few seconds, and then **To register HS, see manual**. This may take up to five minutes to occur. Please start again from Step 1.

## Deregistering handsets

You may need to deregister your handsets if:

- You have 12 registered handsets and need to replace a handset.

### -OR-

- You wish to change the designated handset number of your registered handsets.

You must first deregister ALL the handsets, and then register each handset you wish to use again, one at a time.

**Please read carefully through all the instructions on this page before beginning the deregistration process.**

### Deregister all handsets from your telephone base

1. Make sure that all handsets are out of the telephone base and chargers before you begin deregistration.
2. Press and hold /**HANDSET LOCATOR** on the telephone base for about 10 seconds (until the **IN USE** light starts to flash), then release the /**HANDSET LOCATOR** button.
3. Immediately press /**HANDSET LOCATOR** while the **IN USE** light is still flashing. (The light flashes for about seven seconds. If the light stops flashing, start again with Step 1.)
4. It takes up to 10 seconds to complete the deregistration process. Before registering the handset again, wait for the cordless handset screen to display **To register HS, see manual**.
5. To register the handset(s) to the telephone base again, follow the registration instructions on the previous page.









#### NOTES:

- If the deregistration process is not successful, you might need to reset the system and try again. To reset, unplug the power from the telephone base and plug it back in.
- You cannot deregister the handset(s) if any other system handset is in use.
- Even if the battery is depleted, you can still deregister the handsets by following the steps mentioned above. After the handset is charged for at least 10 minutes, the screen shows **To register HS, see manual**.

## Alert tones and lights

## Screen icons

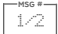
	<b>Battery status</b> - battery is charging (animated display).
	<b>Battery status</b> - low battery (flashing); place handset in telephone base or charger to recharge.
	<b>Speakerphone</b> - the speakerphone is in use.
	<b>Ringer off</b> - the handset ringer is off.
	<b>New voicemail</b> - you have new voicemail from your telephone service provider.
<b>ANS ON</b>	<b>Answering system on</b> - the answering system is turned on to answer calls.
	<b>Message</b> - new message in the built-in answering system.
<b>NEW</b>	<b>New caller ID log</b> - new or missed calls.
<b>MUTE</b>	<b>MUTE</b> - the handset microphone is off.
	<b>Message counter</b> - number of message playing/total number of messages.



## Handset alert tones

<b>1 short beep</b>	Tone of each key press, if key tone is turned on.
<b>1 long beep</b>	Indication to begin recording a message, memo or announcement.
<b>2 short beeps</b>	<p>You are pressing ▼CID or ▲DIR on a cordless handset when the volume is already at its highest or lowest setting.</p> <p><b>-OR-</b></p> <p>Call waiting tone.</p> <p><b>-OR-</b></p> <p>Error tone.</p>
<b>Confirmation tone (3 rising tones)</b>	The system has completed the command successfully.
<b>4 beeps</b>	<p>The other party has ended your intercom call.</p> <p><b>-OR-</b></p> <p>The handset has gone out of range from the base during a call.</p>
<b>4 short beeps</b>	Low battery warning.

## Alert tones and lights

**Telephone base tones**

<b>Beeps every 10 seconds</b>	Message alert.
<b>Fast ringer tone</b>	You are setting the ringer volume by pressing the ▼/ <b>VOL-</b> or ▲/ <b>VOL+</b> key on the telephone base.
<b>Long beep</b>	Indicates the start of message recording during call screening or the end of a message playback session.
<b>4 short beeps</b>	Registration failure tone.

## Appendix

# Alert tones and lights

## Lights



**⏻/ANSWER ON/OFF**

On when the answering system is on.

**IN USE**

- On when the handset is in use, or when the answering system is answering an incoming call.
- On when a handset is being registered.
- Flashes when there is an incoming call or when handsets are being deregistered.
- Flashes when another telephone is in use on the same line.

**CHARGE**

On when the handset is charging in the telephone base or charger.

Lighted display

Lighted key pad

**🔊/SPEAKER**

On when the speakerphone is on.



## Handset display screen messages

## Screen display messages

Caller ID log empty	There are no entries in the caller ID log.
Call transferred	You have transferred an outside call to another cordless handset.
Calling HANDSET X (for systems with 3 or more handsets)	The handset is calling another handset (for intercom calls). The handset is transferring an outside call to another handset.
Calling other handset (for systems with 2 handsets)	The handset is calling the other handset (for intercom calls). The handset is transferring an outside call to the other handset.
CID Annnc ON/OFF on all HS and BS	The caller ID announce features has been turned on or off on all handsets and the telephone base.
Contact deleted	A directory entry is deleted.
Directory empty	There are no directory entries.
Directory full	The directory is full. You cannot save any new entries unless you delete some current entries.
Ended	You have just ended a call.
HANDSET X is calling (for systems with 3 or more handsets)	Another system handset is calling.
Incoming call	There is a call coming in.
Intercom	The handset is on an intercom call.
Intercom ended	The intercom call has just ended.
INTERCOM TO: (for systems with 3 or more handsets)	You have started the intercom process, and need to enter the number of the handset you wish to call.
Line in use	An extension phone, or one of the handsets is in use.
Low battery	The battery is low. You should charge the battery.
Microphone ON	Mute is off so the other party can hear your voice.
Muted	The microphone is off. The other party cannot hear you.
New voicemail	There are new voicemail messages from your telephone service provider.
No battery	The handset in the charger has no battery installed.
No Incoming PTT	The incoming PTT function is turned off. The handset will not receive PTT calls.

## Handset display screen messages

## Screen display messages

No line	There is no telephone line connection.
No answer. Try again.	The handset(s) you are trying to transfer a call to is out of range, off hook, or has no power.
Number already saved	The telephone number you have entered is already in the directory.
Not available at this time	Someone else is already using the directory or caller ID log.
Other handset is calling (for systems with 2 handsets)	The other handset is calling.
Out of range OR No Pwr at base	The telephone base has lost power, or the handset is out of range.
** Paging **	The cordless handset is paged by the telephone base.
Phone	The handset is on a call.
Place in charger	The battery is very low. The handset should be charged.
Rec mem full	The system recording time is full.
Quiet mode on	QUIET mode is on.
Quiet mode is off	QUIET mode is has been turned off.
Rec mem low	The system recording time is low.
Registering... Please wait	The handset is registering to the telephone base.
Registration failed	The handset registration is not successful.
Ringer off	The ringer is turned off.
Ringer muted	The ringer is off temporarily while the handset is ringing.
Saved	An entry has been successfully saved in the directory.
Speaker	The handset speakerphone is in use.
To register HS, see manual.	Screen display before handset registration.
To screen call, press [SELECT]	Press <b>MENU/SELECT</b> to activate call screening.

## Handset display screen messages

## Screen display messages

TRANSFER TO: (for systems with 3 or more handsets)	You have started transferring a call, and need to enter the desired handset number or choose all handsets.
Unable to call. Line in use	Failed phone call (the telephone line is in use).
Unable to call. Try again	You try to join a call when there are already 4 handsets on that call.  You try to make an outside call when another handset is transferring a call with the intercom feature.
XX Missed calls	There are new calls in the caller ID log.
XX New messages	There are new messages in the answering system.



## Troubleshooting

If you have difficulty with your phone, please try the following suggestions. For Customer Service, visit our website at **www.telephones.att.com** or call **1 (800) 222-3111**. In Canada, dial **1 (866) 288-4268**.

### My telephone doesn't work at all.

- Make sure the power cord is securely plugged in.
- Make sure you plug the battery connector securely into the cordless handset.
- Make sure you plug the telephone line cord securely and firmly into the telephone base and the telephone wall jack.
- Charge the battery in the cordless handset for at least 10 hours. For optimum daily performance, return the cordless handset to the telephone base or charger when not in use.
- If the battery is depleted, it might take approximately 30 minutes to charge the handset before it shows **Low battery**. See page 8 for details.
- Reset the telephone base. Unplug the electrical power. Wait for approximately 15 seconds, then plug it back in. Allow up to one minute for the cordless handset and telephone base to reset.
- You may need to purchase a new battery. Please refer to **Battery installation and charging** in this user's manual on pages 8-9.

### The display shows **No line**. I cannot get a dial tone.

- Try all the suggestions, as mentioned above.
- If the previous suggestions do not work, disconnect the telephone line cord from your telephone and connect the telephone line cord to another telephone.
  - If there is no dial tone on that other telephone either, your telephone line cord may be defective. Install a new telephone line cord.
  - If changing the telephone line cord does not help, the wall jack (or the wiring to this wall jack) may be defective. Try using a different wall jack in your home to connect your CL82143 telephone, or contact your telephone service provider (charges may apply).

### **I cannot dial out.**

- Try all the suggestions, as mentioned above.
- Make sure you have a dial tone before dialing. The cordless handset might take a second or two to find the telephone base and produce a dial tone. This is normal. Wait an extra second before dialing.
- Eliminate any background noise. Noise from a television, radio or other appliances might cause the phone to not dial out properly. If you cannot eliminate the background noise, first try muting the cordless handset before dialing, or dialing from another room with less background noise.
- If other phones in your home are having the same problem, contact your telephone service provider (charges might apply).

### **My cordless handset isn't performing normally.**

- Make sure you plug the power cord securely into the telephone base. Plug the power adapter into a different, working electrical outlet without a wall switch.
- Move the cordless handset closer to the telephone base. You might have moved out of range.
- Reset the telephone base. Unplug the electrical power. Wait for 15 seconds, then plug it back in. Allow up to one minute for the cordless handset and telephone base to reset.
- Other electronic products such as HAM radios and other DECT phones, can cause interference with your cordless phone. Try installing your phone as far away as possible from these types of electronic devices.

### **Out of range OR No pwr at base appears on my cordless handset.**

- Ensure you plug the telephone base in properly and the power is on.
- Place the cordless handset in the telephone base for one minute to allow the cordless handset and base to synchronize.
- Move the cordless handset closer to the telephone base. You might have moved out of range.
- Reset the telephone base. Unplug the electrical power. Wait for 15 seconds, then plug it back in. Allow up to one minute for the cordless handset and telephone base to reset.
- Other electronic products such as HAM radios and other DECT phones, can cause interference with your cordless phone. Try installing your phone as far away as possible from these types of electronic devices.

### **The batteries do not hold a charge.**

- If the cordless handset is in the telephone base or charger and the charge light is not on, refer to **The charge light is off** (page 84).
- Charge the battery in the cordless handset for at least 10 hours. For optimum daily performance, return the cordless handset to the telephone base or charger when not in use.
- If the battery is depleted, it might take approximately 30 minutes to charge the handset before it shows **Low battery**. Refer to the table on page 8 for details.
- You might need to purchase a new battery. Please refer to **Battery installation and charging** in this user's manual on pages 8-9.

### **I get noise, static, or weak signals even when I'm near the telephone base.**

- If you subscribe to high-speed Internet service (DSL - digital subscriber line) through your telephone line, you must install a DSL filter between the telephone line cord and the telephone wall jack (see page 7). The filter prevents noise and caller ID problems as a result of DSL interference. Please contact your DSL service provider for more information about DSL filters.
- You may be able to improve the performance of your cordless phone by installing your new telephone base as far as possible from any other existing cordless telephone system that may already be installed.
- Other electronic products such as HAM radios and other DECT phones, can cause interference with your cordless phone. Try installing your phone as far away as possible from these types of electronic devices.
- Do not install this phone near a microwave oven or on the same electrical outlet. You might experience decreased performance while the microwave oven is operating.
- If you plug your phone in with a modem or a surge protector, plug the phone (or modem/surge protector) into a different location. If this does not solve the problem, relocate your phone or modem farther apart from one another, or use a different surge protector.
- Move your phone to a higher location. The phone might have better reception in a high area.
- If other phones in your home are having the same problem, contact your telephone service provider (charges may apply).

**I experience poor sound quality when using the speakerphone.**

- For increased sound quality while using the speakerphone, place the handset on a flat surface with the dial pad facing up.

**I hear other calls while using my phone.**

- Disconnect the telephone base from the telephone jack, and plug in a different telephone. If you still hear other calls, call your telephone service provider.

**My cordless handset does not ring when I receive a call.**

- Make sure that the ringer is not off. Refer to **Ringer volume** on page 12 in this user's manual.
- Make sure you plug in the telephone line cord securely into the telephone base and the telephone jack. Make sure you plug in the power cord securely.
- The cordless handset may be too far from the telephone base.
- Charge the battery in the cordless handset for at least 10 hours. For optimum daily performance, return the cordless handset to the telephone base or charger when not in use.
- You may have too many extension phones on your telephone line to allow all of them to ring simultaneously. Try unplugging some of the other phones.
- The layout of your home or office might be limiting the operating range. Try moving the telephone base to another location, preferably to a higher location.
- If other phones in your home are having the same problem, contact your telephone service provider (charges might apply).
- Test a working phone at the phone jack. If another phone has the same problem, contact your telephone service provider (charges might apply).
- Other electronic products can cause interference with your cordless phone. Try installing your phone as far away as possible from electronic devices such as television sets, VCRs, or other cordless telephones.
- Completely remove the battery. Install the battery again and place the cordless handset into the telephone base. Wait for the cordless handset to reestablish its connection with the telephone base. Allow up to one minute for this to take place.
- Your line cord might be malfunctioning. Try installing a new line cord.

**My calls cut in and out while I'm using my cordless handset.**

- Other electronic products such as HAM radios and other DECT phones, can cause interference with your cordless phone. Try installing your phone as far away as possible from these types of electronic devices.
- Do not install this phone near a microwave oven or on the same electrical outlet. You might experience decreased performance while the microwave oven is operating.
- If you plug your phone in with a modem or surge protector, plug the phone (or modem/surge protector) into a different location. If this does not solve the problem, relocate your phone or modem farther apart from one another, or use a different surge protector.
- Move your telephone base to a higher location. The phone might have better reception when installed in a high area.
- If other phones in your home are having the same problem, contact your telephone service provider (charges may apply).

**The charge light is off.**

- Make sure you plug the power and line cords in correctly and securely.
- Unplug the electrical power. Wait for 15 seconds, then plug it back in. Allow up to one minute for the cordless handset and telephone base to reset.
- Clean the cordless handset, charger and telephone base charging contacts each month with a pencil eraser or cloth.
- The battery may not be connected to the handset or is missing completely. Ensure that the battery is installed properly.

**My caller ID isn't working.**

- Caller ID is a subscription service. You must subscribe to this service from your telephone service provider for this feature to work on your phone.
- The caller may not be calling from an area which supports caller ID.
- Both your and your caller's telephone service providers must use caller ID compatible equipment.
- If you subscribe to high-speed Internet service (DSL - digital subscriber line) through your telephone line, you must install a DSL filter between the telephone line cord and the telephone wall jack (page 7). The filter prevents noise and caller ID problems resulting from DSL interference. Please contact your DSL service provider for more information about DSL filters.

### **System does not receive caller ID when on a call.**

- Make sure you subscribe to caller ID with call waiting features from your telephone service provider. Caller ID features works only if both you and the caller are in areas offering caller ID service, and if both telephone service providers use compatible equipment.

### **Incomplete messages.**

- If a caller leaves a very long message, part of it may be lost when the system disconnects the call after the maximum recording time you have set.
- If the caller pauses for longer than seven seconds, the system stops recording and disconnects the call.
- If the system's memory becomes full during a message, the system stops recording and disconnects the call.
- If the caller's voice is very soft, the system may stop recording and disconnect the call.

### **Difficulty hearing messages.**

- Press **▲/VOL+** to increase the telephone base speaker volume.
- Press **▲DIR/VOLUME** to adjust the message playback volume on a handset.

### **System does not answer after the correct number of rings.**

- Make sure that the answering system is on. **ANS ON** should show on the handset and the **📞/ANSWER ON/OFF** light on the telephone base should be on.
- If toll saver is activated, the number of rings changes to 2 when you have new messages stored (pages 57-58).
- If the memory is full or the system is off, the system will answer after 10 rings.
- In some cases, the answering system is affected by the ringing system used by your telephone service provider.
- If you subscribe to voicemail service, change the number of rings (pages 57-58) so that your answering system answers before your voicemail. To determine how many rings activate your voicemail, contact your telephone service provider.
- If there is a fax machine connected to the same telephone line, try disconnecting the fax machine. If that solves the problem, consult your fax machine documentation for information on compatibility with answering systems.

## Troubleshooting

### **System does not respond to remote commands.**

- Make sure to enter your remote access code correctly (page 58).
- Make sure you are calling from a touch-tone phone. When you dial a number, you should hear tones. If you hear clicks, the phone is not a touch-tone telephone and cannot activate the answering system.
- The answering system may not detect the remote access code while your announcement is playing. Try waiting until the announcement is over before entering the code.
- There may be interference on the phone line you are using. Press dialing keys firmly.

### **System does not record messages.**

- Make sure the answering system is on. **ANS ON** should show on the handset and the /ANSWER ON/OFF light on the telephone base should be on.
- Make sure the memory of the answering system is not full.
- If you subscribe to voicemail service, change the number of rings (pages 57-58) so that your answering system answers before your voicemail. To determine how many rings activate your voicemail, contact your telephone service provider.
- If there is a fax machine connected to the same telephone line, try disconnecting the fax machine. If that solves the problem, consult your fax machine documentation for information on compatibility with answering systems.

### **System announces, “Time and day not set.”**

- You need to reset the system clock (page 13).

### **Outgoing announcement is not clear.**

- When you record your announcement, make sure you speak in a normal tone of voice, about 9 inches from the handset.
- Make sure there is no background noise (TV, music, etc.) while recording.

# Troubleshooting

## **New voicemail and show on the handset display, and I don't know why.**

- Your telephone has both a built-in answering system and voicemail indication. If **New voicemail** and  appear on the handset display, then your telephone has received a signal from your telephone service provider that you have a voicemail message waiting for you to retrieve from them. Contact your telephone service provider for more information on how to access your voicemail.

## **I cannot retrieve voicemail messages.**

- Your telephone has both a built-in answering system and voicemail indication. They are independent features and each alerts you to new messages differently (page 60). If you subscribe to voicemail service from your telephone service provider, contact your telephone service provider for more information on how to access your voicemail.

## **I've set my LCD language to Spanish or French and I don't know how to change it back to English.**

- Press **MENU/SELECT** in idle mode, then enter **364#** using the dialing keys. You hear a confirmation tone.

## **I subscribe to a nontraditional telephone service that uses my computer to establish connections, and my telephone doesn't work.**

- Make sure your computer is powered on.
- Make sure your Internet connection is working properly.
- Make sure that the software is installed and running for your nontraditional telephone service.
- Make sure to plug your USB telephone adapter into a dedicated USB port on your computer. Do not plug it into a multiple port USB hub (USB splitter) that is not powered.
- In a few rare instances, the USB port on your computer may not have enough power. Try using a USB hub with its own external power supply.
- If you are using a firewall, it may prevent access to your nontraditional telephone service provider. Contact your service provider for more information.



## Troubleshooting

### **Common cure for electronic equipment.**

If the telephone does not seem to be responding normally, try putting the cordless handset in the telephone base or charger. If it does not fix the problem, do the following (in the order listed):

1. Disconnect the power to the telephone base.
2. Disconnect the cordless handset battery.
3. Wait a few minutes.
4. Connect power to the telephone base.
5. Completely remove the battery. Replace the battery and place the cordless handset into the telephone base or charger.
6. Wait for the cordless handset to reestablish its connection with the telephone base. Allow up to one minute for this to take place.

### **Taking care of your telephone**

- Your cordless telephone contains sophisticated electronic parts, so you must treat it with care.
- Avoid rough treatment.
- Place the handset down gently.
- Save the original packing materials to protect your telephone if you ever need to ship it.

### **Avoid water**

- You can damage your telephone if it gets wet. Do not use the handset in the rain, or handle it with wet hands. Do not install the telephone base near a sink, bathtub or shower.

### **Electrical storms**

- Electrical storms can sometimes cause power surges harmful to electronic equipment. For your own safety, take caution when using electric appliances during storms.

### **Cleaning your telephone**

- Your telephone has a durable plastic casing that should retain its luster for many years. Clean it only with a soft cloth slightly dampened with water or mild soap.
- Do not use excess water or cleaning solvents of any kind.

Remember that electrical appliances can cause serious injury if used when you are wet or standing in water. If the telephone base should fall into water, DO NOT RETRIEVE IT UNTIL YOU UNPLUG THE POWER CORD AND TELEPHONE LINE CORDS FROM THE WALL. Pull the unit out by the unplugged cords.

# Important safety information



This symbol is to alert you to important operating or servicing instructions that may appear in this user's manual. Always follow basic safety precautions when using this product to reduce the risk of injury, fire, or electric shock.

## Safety information

- Read and understand all instructions in the user's manual. Observe all markings on the product.
- Avoid using a telephone during a thunderstorm. There may be a slight chance of electric shock from lightning.
- Do not use a telephone in the vicinity of a gas leak. Under certain circumstances, a spark may be created when the adapter is plugged into the power outlet, or when the handset is replaced in its cradle. This is a common event associated with the closing of any electrical circuit. The user should not plug the phone into a power outlet, and should not put a charged handset into the cradle, if the phone is located in an environment containing concentrations of flammable or flame-supporting gases, unless there is adequate ventilation. A spark in such an environment could create a fire or explosion. Such environments might include: medical use of oxygen without adequate ventilation; industrial gases (cleaning solvents; gasoline vapors; etc.); a leak of natural gas; etc.
- Do not use this product near water, or when you are wet. For example, do not use it in a wet basement or shower, or next to a swimming pool, bathtub, kitchen sink, or laundry tub. Do not use liquids or aerosol sprays for cleaning. If the product comes in contact with any liquid, unplug any line or power cord immediately. Do not plug the product back in until it has dried thoroughly.
- Install this product in a protected location where no one can trip over any line or power cords. Protect cords from damage or abrasion.
- If this product does not operate normally, see the **Troubleshooting** section on pages 80-88 of this user's manual. If you cannot solve the problem, or if the product is damaged, refer to the **Limited warranty** section on pages 97-98. Do not open this product except as directed in your user's manual. Opening the product or reassembling it incorrectly may expose you to hazardous voltages or other risks.
- Replace batteries only as described in your user's manual (pages 8-9). Do not burn or puncture batteries — they contain caustic chemicals.
- This power adapter is intended to be correctly oriented in a vertical or floor mount position. The prongs are not designed to hold the plug in place if it is plugged into a ceiling or an under-the-table/cabinet outlet.



### CAUTIONS:

- Use only the power adapters provided with this product. To obtain a replacement, visit our website at **[www.telephones.att.com](http://www.telephones.att.com)** or call **1 (800) 222-3111**. In Canada, dial **1 (866) 288-4268**.
- Use only the supplied rechargeable battery or replacement battery (model BT183342/BT283342). To order, visit our website at **[www.telephones.att.com](http://www.telephones.att.com)** or call **1 (800) 222-3111**. In Canada, dial **1 (866) 288-4268**.
- To prevent risk of fire or battery explosion, replace with the correct battery type. Dispose of used batteries according to the instructions.

# Important safety information

## Especially about cordless telephones

- **Privacy:** The same features that make a cordless telephone convenient create some limitations. Telephone calls are transmitted between the telephone base and the handset by radio waves, so there is a possibility that your cordless telephone conversations could be intercepted by radio receiving equipment within range of the cordless handset. For this reason, you should not think of cordless telephone conversations as being as private as those on corded telephones.
- **Electrical power:** The telephone base of this cordless telephone must be connected to a working electrical outlet which is not controlled by a wall switch. Calls cannot be made from the handset if the telephone base is unplugged, switched off or if the electrical power is interrupted.
- **Potential TV interference:** Some cordless telephones operate at frequencies that may cause interference to TVs and VCRs. To minimize or prevent such interference, do not place the telephone base of the cordless telephone near or on top of a TV or VCR. If interference is experienced, moving the cordless telephone farther away from the TV or VCR will often reduce or eliminate the interference.
- **Rechargeable batteries:** This product contains nickel-metal hydride rechargeable batteries. Exercise care in handling batteries in order not to create a short circuit with conductive material such as rings, bracelets and keys. The battery or conductor may overheat and cause harm. Observe proper polarity between the battery and the battery charger.
- **Nickel-metal hydride rechargeable batteries:** Dispose of these batteries in a safe manner. Do not burn or puncture. Like other batteries of this type, if burned or punctured, they could release caustic material which could cause injury.



The RBRC® Seal means that the manufacturer is voluntarily participating in an industry program to collect and recycle nickel-metal hydride rechargeable batteries when taken out of service within the United States. These batteries may be taken to a participating local retailer of replacement batteries or recycling center. Or you may call 1-800-8-BATTERY® for locations accepting spent Ni-MH batteries.

RBRC® and 1-800-8-BATTERY® are registered trademarks of the Rechargeable Battery Recycling Corporation.

## Precautions for users of implanted cardiac pacemakers

Cardiac pacemakers (applies only to digital cordless telephones):

Wireless Technology Research, LLC (WTR), an independent research entity, led a multidisciplinary evaluation of the interference between portable wireless telephones and implanted cardiac pacemakers. Supported by the U.S. Food and Drug Administration, WTR recommends to physicians that:

### Pacemaker patients

Should keep wireless telephones at least six inches from the pacemaker.

Should NOT place wireless telephones directly over the pacemaker, such as in a breast pocket, when it is turned ON.

Should use the wireless telephone at the ear opposite the pacemaker.

WTR's evaluation did not identify any risk to bystanders with pacemakers from other persons using wireless telephones.

## Important safety information

### **Especially about telephone answering systems**

Two-way recording: This unit does not sound warning beeps to inform the other party that the call is being recorded. To ensure that you are in compliance with any federal or state regulations regarding recording a telephone call, you should start the recording process and then inform the other party that you are recording the conversation.

## **SAVE THESE INSTRUCTIONS**

## FCC Part 68 and ACTA

This equipment complies with Part 68 of the FCC rules and with technical requirements adopted by the Administrative Council for Terminal Attachments (ACTA). The label on the back or bottom of this equipment contains, among other things, a product identifier in the format US:AAAEQ##TXXXX. This identifier must be provided to your telephone service provider upon request.

The plug and jack used to connect this equipment to premises wiring and the telephone network must comply with the applicable Part 68 rules and technical requirements adopted by ACTA. A compliant telephone cord and modular plug is provided with this product. It is designed to be connected to a compatible modular jack that is also compliant. An RJ11 jack should normally be used for connecting to a single line and an RJ14 jack for two lines. See the installation instructions in the user's manual.

The Ringer Equivalence Number (REN) is used to determine how many devices you may connect to your telephone line and still have them ring when you are called. The REN for this product is encoded as the 6th and 7th characters following the US: in the product identifier (e.g., if ## is 03, the REN is 0.3). In most, but not all areas, the sum of all RENs should be five (5.0) or less. For more information, please contact your telephone service provider.

This equipment may not be used with Party Lines. If you have specially wired alarm dialing equipment connected to your telephone line, ensure the connection of this equipment does not disable your alarm equipment. If you have questions about what will disable the alarm equipment, consult your telephone service provider or a qualified installer.

If this equipment is malfunctioning, it must be unplugged from the modular jack until the problem has been corrected. Repairs to this telephone equipment can only be made by the manufacturer or its authorized agents. For repair procedures, follow the instructions outlined under the Limited warranty.

If this equipment is causing harm to the telephone network, the telephone service provider may temporarily discontinue your telephone service. The telephone service provider is required to notify you before interrupting service. If advance notice is not practical, you will be notified as soon as possible. You will be given the opportunity to correct the problem and the telephone service provider is required to inform you of your right to file a complaint with the FCC. Your telephone service provider may make changes in its facilities, equipment, operation, or procedures that could affect the proper functioning of this product. The telephone service provider is required to notify you if such changes are planned.

If this product is equipped with a corded or cordless handset, it is hearing aid compatible.

If this product has memory dialing locations, you may choose to store emergency telephone numbers (e.g., police, fire, medical) in these locations. If you do store or test emergency numbers, please:

Remain on the line and briefly explain the reason for the call before hanging up.

Perform such activities in off-peak hours, such as early morning or late evening.

## FCC Part 68 and ACTA

### **Industry Canada**

This device complies with Industry Canada license-exempt RSS standard(s).

Operation is subject to the following two conditions: (1) this device may not cause harmful interference, and (2) this device must accept any interference received, including interference that may cause undesired operation.

Privacy of communications may not be ensured when using this telephone.

The term "IC:" before the certification/registration number only signifies that the Industry Canada technical specifications were met.

The Ringer Equivalence Number (REN) for this terminal equipment is 1.0. The REN is an indication of the maximum number of devices allowed to be connected to a telephone interface. The termination on an interface may consist of any combination of devices subject only to the requirement that the sum of the RENs of all the devices does not exceed five.

This product meets the applicable Industry Canada technical specifications.

## Appendix

# FCC Part 15

This equipment has been tested and found to comply with the requirements for a Class B digital device under Part 15 of the Federal Communications Commission (FCC) rules. These requirements are intended to provide reasonable protection against harmful interference in a residential installation. This equipment generates, uses and can radiate radio frequency energy and, if not installed and used in accordance with the instructions, may cause harmful interference to radio communications. However, there is no guarantee that interference will not occur in a particular installation. If this equipment does cause harmful interference to radio or television reception, which can be determined by turning the equipment off and on, the user is encouraged to try to correct the interference by one or more of the following measures:

- Reorient or relocate the receiving antenna.
- Increase the separation between the equipment and receiver.
- Connect the equipment into an outlet on a circuit different from that to which the receiver is connected.
- Consult the dealer or an experienced radio/TV technician for help.

Changes or modifications to this equipment not expressly approved by the party responsible for compliance could void the user's authority to operate the equipment.

This device complies with Part 15 of the FCC Rules. Operation is subject to the following two conditions: (1) this device may not cause harmful interference, and (2) this device must accept any interference received, including interference that may cause undesired operation. Privacy of communications may not be ensured when using this telephone.

To ensure safety of users, the FCC has established criteria for the amount of radio frequency energy that can be safely absorbed by a user or bystander according to the intended usage of the product. This product has been tested and found to comply with the FCC criteria. The handset may be safely held against the ear of the user. The telephone base shall be installed and used such that parts of the user's body other than the hands are maintained at a distance of approximately 20 cm (8 inches) or more.



This Class B digital apparatus complies with Canadian requirement:  
CAN ICES-3 (B)/NMB-3(B)



# California Energy Commission battery charging testing instructions

This telephone is set up to comply with the energy-conserving standards right out of the box. These instructions are intended for California Energy Commission (CEC) compliance testing only. When the CEC battery charging testing mode is activated, all telephone functions, except battery charging, will be disabled.

## To activate the CEC battery charging testing mode:

1. Unplug the telephone base power adapter from the power outlet. Make sure all handsets are plugged with charged batteries before proceeding.
2. While you press and hold /HANDSET LOCATOR, plug the telephone base power adapter back to the power outlet.
3. After about 20 seconds, when the **IN USE** light starts flashing, release /HANDSET LOCATOR and then press it again within two seconds.



The process takes up to one minute to complete. When the phone successfully enters the CEC battery charging testing mode, the **IN USE** light turns off and all handsets display

**To register HS, see manual.** You hear a confirmation tone.

When the phone fails to enter this mode, repeat the steps mentioned above.

**Note:** The telephone base will be powered up as normal if you fail to press /HANDSET LOCATOR within two seconds in Step 3.

## To deactivate the CEC battery charging testing mode:

1. Unplug the telephone base power adapter from the power outlet, then plug it back in. The telephone base is powered up as normal.
2. Register your handsets back to the telephone base. See pages 71-72 for handset registration instructions.



## Limited warranty

The AT&T brand is used under license - any repair, replacement or warranty service, and all questions about this product should be directed to our website at **www.telephones.att.com** or call **1 (800) 222-3111**. In Canada, dial **1 (866) 288-4268**.

### 1. What does this limited warranty cover?

The manufacturer of this AT&T branded product warrants to the holder of a valid proof of purchase ("CONSUMER" or "you") that the product and all accessories provided in the sales package ("PRODUCT") are free from defects in material and workmanship, pursuant to the following terms and conditions, when installed and used normally and in accordance with the PRODUCT operating instructions. This limited warranty extends only to the CONSUMER for products purchased and used in the United States of America and Canada.

### 2. What will be done if the PRODUCT is not free from defects in materials and workmanship during the limited warranty period ("materially defective PRODUCT")?

During the limited warranty period, the manufacturer's authorized service representative will repair or replace at the manufacturer's option, without charge, a materially defective PRODUCT. If the manufacturer repairs the PRODUCT, they may use new or refurbished replacement parts. If the manufacturer chooses to replace the PRODUCT, they may replace it with a new or refurbished PRODUCT of the same or similar design. The manufacturer will retain defective parts, modules, or equipment. Repair or replacement of the PRODUCT, at the manufacturer's option, is your exclusive remedy. The manufacturer will return repaired or replacement products to you in working condition. You should expect the repair or replacement to take approximately 30 days.

### 3. How long is the limited warranty period?

The limited warranty period for the PRODUCT extends for ONE (1) YEAR from the date of purchase. If the manufacturer repairs or replaces a materially defective PRODUCT under the terms of this limited warranty, this limited warranty also applies to repaired or replacement PRODUCT for a period of either (a) 90 days from the date the repaired or replacement PRODUCT is shipped to you or (b) the time remaining on the original one-year limited warranty; whichever is longer.

### 4. What is not covered by this limited warranty?

This limited warranty does not cover:

- PRODUCT that has been subjected to misuse, accident, shipping or other physical damage, improper installation, abnormal operation or handling, neglect, inundation, fire, water, or other liquid intrusion; or
- PRODUCT that has been damaged due to repair, alteration, or modification by anyone other than an authorized service representative of the manufacturer; or
- PRODUCT to the extent that the problem experienced is caused by signal conditions, network reliability or cable or antenna systems; or
- PRODUCT to the extent that the problem is caused by use with non-AT&T accessories; or
- PRODUCT whose warranty/quality stickers, PRODUCT serial number plates or electronic serial numbers have been removed, altered or rendered illegible; or
- PRODUCT purchased, used, serviced, or shipped for repair from outside the United States of America or Canada, or used for commercial or institutional purposes (including but not limited to products used for rental purposes); or
- PRODUCT returned without valid proof of purchase (see item 6); or
- Charges for installation or setup, adjustment of customer controls, and installation or repair of systems outside the unit.

## Limited warranty

### 5. How do you get warranty service?

To obtain warranty service, visit our website at **www.telephones.att.com** or call **1 (800) 222-3111**. In Canada, dial **1 (866) 288-4268**.

NOTE: Before calling for service, please review the user's manual; a check of the PRODUCT's controls and features may save you a service call.

Except as provided by applicable law, you assume the risk of loss or damage during transit and transportation and are responsible for delivery or handling charges incurred in the transport of the PRODUCT(s) to the service location. The manufacturer will return repaired or replaced PRODUCT under this limited warranty to you. Transportation, delivery or handling charges are prepaid. The manufacturer assumes no risk for damage or loss of the PRODUCT in transit. If the PRODUCT failure is not covered by this limited warranty, or proof of purchase does not meet the terms of this limited warranty, the manufacturer will notify you and will request that you authorize the cost of repair prior to any further repair activity. You must pay for the cost of repair and return shipping costs for the repair of products that are not covered by this limited warranty.

### 6. What must you return with the PRODUCT to get warranty service?

You must:

- Return the entire original package and contents including the PRODUCT to the service location along with a description of the malfunction or difficulty; and
- Include a "valid proof of purchase" (sales receipt) identifying the PRODUCT purchased (PRODUCT model) and the date of purchase or receipt; and
- Provide your name, complete and correct mailing address, and telephone number.

### 7. Other limitations

This warranty is the complete and exclusive agreement between you and the manufacturer of this AT&T branded PRODUCT. It supersedes all other written or oral communications related to this PRODUCT. The manufacturer provides no other warranties for this PRODUCT. The warranty exclusively describes all of the manufacturer's responsibilities regarding the PRODUCT. There are no other express warranties. No one is authorized to make modifications to this limited warranty and you should not rely on any such modification.

State/Provincial Law rights: This warranty gives you specific legal rights, and you may also have other rights which vary from state to state or province to province.

Limitations: Implied warranties, including those of fitness for a particular purpose and merchantability (an unwritten warranty that the PRODUCT is fit for ordinary use) are limited to one year from date of purchase. Some states/provinces do not allow limitations on how long an implied warranty lasts, so the above limitation may not apply to you. In no event shall the manufacturer be liable for any indirect, special, incidental, consequential, or similar damages (including, but not limited to lost profits or revenue, inability to use the PRODUCT or other associated equipment, the cost of substitute equipment, and claims by third parties) resulting from the use of this PRODUCT. Some states/provinces do not allow the exclusion or limitation of incidental or consequential damages, so the above limitation or exclusion may not apply to you.

**Please retain your original sales receipt as proof of purchase.**

## Appendix

# Technical specifications

RF frequency band	1921.536MHz - 1928.448MHz
Channels	5
Operating temperature	32°F - 122°F 0°C - 50°C
Telephone base voltage (AC voltage, 60Hz)	96Vrms - 130Vrms
Telephone base voltage (AC adapter output)	6VDC @ 400mA
Handset voltage	2.4 VDC, AAA x 2, Ni-MH
Charger voltage (AC adapter output)	6VAC @ 300mA

Operation	Operating time*
Talk time (cordless handset)	Up to 7 hours
Talk time (cordless handset speakerphone)	Up to 5 hours
Standby	Up to 7 days

\* Operating times vary depending on your actual use and the age of the battery.

### DECT 6.0 digital technology

The AT&T DECT 6.0 products offer unsurpassed range performance and sound clarity. This is achieved through a unique antenna design and advances in noise-filtering technology. An independent laboratory has confirmed that AT&T DECT 6.0 products perform up to 45% better in range competitions against similarly equipped phones of the leading competition. Now, calls can be taken in the basement, backyard and garage with exceptional sound quality.

### Telephone operating range

This cordless telephone operates within the maximum power allowed by the Federal Communications Commission (FCC). Even so, this handset and telephone base can communicate over a certain distance — which can vary with the locations of the telephone base and handset, the weather, and the construction of your home or office.

### Redefining long range coverage and clarity

This telephone base comes with an antenna which gives much better clarity and covers a longer range than before.

### HD audio with equalizer for customized audio

HD audio improves sound quality by expanding and rebuilding frequencies that are lost with traditional phone calls. There is no additional telephone service requirement to use HD audio. It is designed to work with standard telephone service. Your system will automatically enhance all received sound with HD audio. Choose from 4 preset audio profiles. The equalizer feature allows you to select from profiles that emphasize bass, treble, and natural tones to meet your individual hearing needs.

## Index

**A**

---

- Alert tones, 74
- Answer an incoming call,
  - During an intercom call, 31
  - During PTT, 37
- Answering calls, 22
- Answering system, 54–70
- Assign a speed dial entry, 45
- Auto off, 22

**B**

---

- Battery charging, 9
- Battery installation, 8–9
- Blind transfer, 28

**C**

---

- Call screening, 62
- Call transfer, 28
  - Using intercom, 32
- Call waiting, 26
- Caller ID (CID),
  - Add entries to phone directory, 52
  - Delete entries, 51
  - Dial entries, 51
  - Review entries, 50
- Caller ID announce, 15
- Chain dialing, 27
- Clock, 13

**D**

---

- Day and time, 13
- Delete a speed dial number, 46
- Delete caller ID log entries, 51
- Dialing,
  - From a record in the caller ID log, 51
  - From the directory, 43

- Directory,
  - Dial number, 43
  - Edit an entry, 44
  - Name search, 42
  - New entries, 39
- Display dial, 43
- DSL, 7

**E**

---

- Ending calls, 22

**F**

---

- Flash (switch hook flash), 26

**H**

---

- Handset,
  - Handset locator, 29
  - Quick reference guide, 2–4
  - Ringer tone, 12
  - Ringer volume, 12
  - Screen display messages, 77–79
  - Screen icons, 74
  - Speakerphone, 23
  - Temporary ringer silencing, 23
  - Voicemail indicator, 17
- HD audio, 99

**I**

---

- Important safety information, 90–92
- Incoming caller ID log, 49–50
- Installation, 6–11
- Intercom, 30–32

**L**

---

- Last number redial, 24
- LCD language, 14
  - Reset to English, 14, 87
- Lights, 76
- Limited warranty, 97–98

# Index

## M

---

Maintenance, 89  
Making calls, 22  
Memory match, 50  
Message,  
    Alert tone, 59  
    Counter display, 68  
    Playback, 64  
Mute, 26

## N

---

Names,  
    Enter into directory, 39  
    Search for, 42  
Number of rings, 57

## O

---

On-hook dialing (predialing), 22  
Outgoing announcement, 54

## P

---

Paging tone, 29  
Phonebook, 38  
Power adapter, 7  
Predialing, 22  
Push to talk, 33–37

## Q

---

Quick reference guide, 2–5  
QUIET mode, 21

## R

---

Reassign a speed dial number, 46  
Receiving calls, 22  
Recharging, 9  
Remote access, 58, 69–70  
Ringer silencing, 23

Ringer volume,  
    Base, 62  
    Handset, 12  
Ring tone options, 13

## S

---

Safety information, 90–92  
Search by name, 42  
Speakerphone, 23  
Speed dial, 45–47  
    Assign or reassign number, 45, 46  
    Delete number, 46  
    Make a call, 47  
    Set voicemail number, 16

## T

---

Technical specifications, 99  
Telephone operating range, 99  
Temporary ringer silencing, 23  
Time, setting, 13  
Transfer (blind), 28  
Troubleshooting, 80–88

## V

---

Visual message waiting indicator, 17  
Voice language, 15  
Voicemail, 16, 17, 60  
    Quick access, 16, 47  
Voice prompts, 62  
Volume control,  
    Base, 62  
    Handset, 12, 26

## W

---

Wall-mount installation, 10  
Warranty, 97–98

# Remote access wallet card

Use the following wallet card to help you remember commands to control your answering system from any touch-tone telephone.

Cut along dotted line.



Call your phone number,  
then enter your two-digit  
access code (preset to **19**).

Action	Remote command
--------	----------------

Play all messages .....	<b>1</b>
Play new messages.....	<b>2</b>
Delete the message.....	<b>3</b>
Delete all old messages .....	<b>33</b>
Repeat or go back .....	<b>4</b>
Stop.....	<b>5</b>
Help menu .....	<b>TONE X 5</b>

Fold here.

Skip the message.....	<b>6</b>
Record announcement .....	<b>TONE X 7</b>
End remote access call .....	<b>8</b> (or hang up)
Turn system off or on .....	<b>0</b>

**Models:** CL82143  
**Type:** DECT 6.0 cordless telephone/answering system with  
caller ID/call waiting

© 2014-2015 Advanced American Telephones. All Rights Reserved.  
AT&T and the AT&T logo are trademarks of AT&T Intellectual Property  
licensed to Advanced American Telephones, San Antonio, TX 78219.  
Printed in China.



**[www.telephones.att.com](http://www.telephones.att.com)**

© 2014-2015 Advanced American Telephones. All Rights Reserved.  
AT&T and the AT&T logo are trademarks of AT&T Intellectual Property licensed to  
Advanced American Telephones, San Antonio, TX 78219.  
RBRC® and 1-800-8-BATTERY® are registered trademarks of the  
Rechargeable Battery Recycling Corporation.  
Printed in China. Issue 3.0 AT&T 02/15.